

Claibourne Township Union County, Ohio

Zoning Code

As Amended: Dec 14, 2018

This version: Amended and restated to reflect amendments as effective December 14, 2018.

Table of Contents

Preamble		
Article I	Title, Interpretation, and Enactment	7
Section 100	Title	7
Section 101	Use of Land or Buildings for Agriculture Purposes Not Affected	7
Section 110	Provisions of Resolution Declared to be the Minimum Requirements	7
Section 120	Separability Clause	7
Section 130	Replacement of Existing Resolution, Effective Date	7
Article II	Definitions	8
Article III	Enforcement	28
Section 300	Zoning Permits Required	28
Section 301	Contents of Application for Zoning Permit	28
Section 302	Approval of Zoning Permit	28
Section 303	Submission to Director of Transportation	29
Section 304	Expiration of Zoning Permit	29
Section 310	Certificate of Occupancy	29
Section 311	Temporary Certificate of Occupancy	30
Section 312	Record of Zoning Permits and Certification of Occupancy	30
Section 320	Failure to Obtain a Zoning Permit or Certificate of Occupancy	30
Section 330	Construction and Use to be as provided in Applications, Plans, Permits and Certificates	30
Section 340	Complaints Regarding Violation	30
Section 350	Penalties for Violations	30
Section 360	Schedule of Fees, Charges, and Expenses	31
Article IV	Non-Conformities	32
Section 400	Intent	32
Section 410	Incompatibility of Non-Conformities	32
Section 420	Avoidance of Undue Hardship	32
Section 430	Single Non-Conforming Lots of Record	32
Section 431	Non-Conforming Lots of Record in Combination	33
Section 440	Non-Conforming Use of Land	33
Section 450	Non-Conforming Structures	34
Section 456	Non-Conforming Uses of Structures or of Structures and Land in Combination	34
Section 470	Repairs and Maintenance	35
Section 480	Uses Under Conditional Use Provisions Not Non-Conforming Uses	35
Article V	Administration	36
Section 500	Office of Zoning Inspector Created	36
Section 501	Duties of Zoning Inspector	36
Section 510	Proceedings of Zoning Commission	36
Section 511	Duties of Zoning Commission	36
Section 520	Board of Zoning Appeals Created	37
Section 521	Proceedings of the Board of Zoning Appeals	37
Section 522	Duties of the Board of Zoning Appeals	37

Section 530	Duties of the Zoning Inspector, Board of Zoning Appeals Legislative Authority and Courts on Matters of Appeal	38
Section 540	Procedures and Requirements for Appeals and Variances	38
Section 541	Appeals	38
Section 542	Stay of Proceedings	39
Section 543	Variances	39
Section 544	Application and Standards for Variances	39
Section 545	Supplementary Conditions and Safeguards	40
Section 546	Public Hearing by the Board of Zoning Appeals	40
Section 547	Notice of Public Hearing in the Newspaper	40
Section 548	Notice to Parties of Interest	41
Section 549	Action by Board of Zoning Appeals	41
Section 560	Procedure and Requirements for Approval of Conditional Use Permits	41
Section 561	General	41
Section 562	Contents of Application for Conditional Use Permit	41
Section 563	General Standards Applicable to all Conditional Uses	42
Section 565	Supplementary Conditions and Safeguards	43
Section 566	Procedure for Hearing, Notice	43
Section 567	Action by the Board of Zoning Appeals	43
Section 568	Expiration of Conditional Use Permit	43
Article VI	Amendment	44
		44
Section 600	Procedure for Amendment or District Changes	44
Section 601	General	44
Section 602	Initiation of Zoning Amendments	44
Section 603	Contents of Application	44
Section 604	Transmittal to Zoning Commission	45
Section 605	Submission to Director of Transportation	45
Section 606	Recommendation by Zoning Commission	45
Section 607	Public Hearing by Township Trustees	46
Section 608	Notice of Public Hearing in Newspaper	46
Section 610	Action by Township Trustees	46
Section 611	Effective Date and Referendum	46
Article VII	Provisions for Official Zoning Map	47
Section 700	Official Zoning Map	47
Section 710	Identification of the Official Zoning Map	47
Section 720	Interpretation of District Boundaries	47
Section 730	Replacement of the Official Zoning Map	47
Article VIII	Establishment and Purpose of Districts	49
Section 800	Intent	49
Section 810	Rural District (U-1)	49
Section 811	Low Density Residential District (R-1)	49
Section 812	Medium Density Residential District (R-2)	49
Section 813	High Density Residential District (R-3)	49
Section 814	Local Business District (B-2)	50
Section 815	Light Manufacturing District (M-1)	50
Article IX	District Regulations	51
Section 900	Compliance with Regulations	51
Section 910	Official Schedule of District Regulations	51

Article X	Supplementary District Regulations	55
Section 1000	General	55
Section 1001	Conversion of Dwellings to More Units	55
Section 1002	Private Swimming Pools	55
Section 1003	Community or Club Swimming Pools	55
Section 1004	Temporary Buildings	56
Section 1005	Parking and Storage of Certain Vehicles	56
Section 1010	Supplemental Yard and Height Regulations	57
Section 1011	Setback Requirements for Corner Buildings	57
Section 1012	Visibility at Intersections	57
Section 1014	Yard Requirements for Multi-Family Dwellings	57
Section 1015	Side and Rear Yard Requirements for Non-Residential Uses Abutting Residential Districts	57
Section 1016	Architectural Projections	58
Section 1017	Exceptions to Height Regulations	58
Section 1020	Special Provisions for Commercial and Industrial Uses	58
Section 1021	Fire Hazards	58
Section 1022	Electrical Disturbance	58
Section 1024	Water Pollution	58
Section 1025	Mining, Mineral, Sand and Gravel Extraction; Storage and Processing	59
Section 1026	Distance from Residential Areas	59
Section 1027	Filing of Location Map	59
Section 1028	Information on Operations	59
Section 1029	Restoration of Mined Area	59
Section 1030	Performance Bond	59
Section 1031	Enforcement Provisions	59
Section 1032	Measurement Procedures	59
Section 1035	General Conditions for Medical Marijuana Entities	60
Section 1040	Roadside Produce Stands	60
Section 1050	Storage of Toxic or Hazardous Material	60
Section 1055	Satellite Television Antenna	61
Section 1060	Effective Screening of Junk Storage and/or Sales of Junk	61
Section 1065	Garage, Porch, Yard or Similar Type Sales	61
Section 1067	Mobile Trailers Prohibited for Business, Storage and Sign Purposes	62
Section 1070	Small Wind Projects less than 5MW	62
Section 1075	General Conditions for Adult Entertainment Use	64
Article XI	Off Street Parking & Loading Requirements	66
Section 1100	General Requirements	66
Section 1110	Parking Space Dimensions	66
Section 1111	Loading Space Requirements and Dimensions	66
Section 1112	Paving	67
Section 1116	Location of Parking Spaces	67
Section 1117	Screening and/or Landscaping	67
Section 1119	Minimum Distance and Setbacks	67
Section 1120	Joint Use	67
Section 1121	Wheel Blocks	68
Section 1122	Width of Driveway Aisles	68
Section 1130	Parking Space Requirements	68
Section 1131	General Interpretations	68
Article XII	Signs	70

Section 1200	Intent	70
Section 1201	Governmental Signs Excluded	70
Section 1202	General Requirements for all Signs and Districts	70
Section 1203	Measurement of Sign Area	71
Section 1210	Signs Permitted in all Districts Not Requiring a Permit	71
Section 1211	Signs Permitted in Any District Requiring a Permit	71
Section 1212	Signs Permitted in Business and Manufacturing Districts Requiring a Permit	71
Section 1220	Temporary Signs	72
Section 1221	Free-Standing Signs	72
Section 1222	Wall Signs Pertaining to Non-Conforming Uses	72
Section 1230	Political Signs	72
Section 1240	Sign Setback Requirements	72
Section 1241	Increased Setback	73
Section 1243	Setbacks for Public and Quasipublic Signs	73
Section 1244	Special Yard Provisions	73
Section 1250	Limitations	73
Section 1251	Violations	73
Article XIII	Manufactured and/or Mobile Home Parks & Manufactured and/or Mobile Homes Individually	74
		74
Section 1300	Intent	74
Section 1310	Approval Procedures	74
Section 1320	General Standards for Manufactured and/or Mobile Home Parks	74
Section 1330	Manufactured and/or Mobile Home Park Requirements	74
Section 1341	Manufactured and/or Mobile Homes Individually	74
	Signature Blocks	76

PREAMBLE

A resolution of the Township of Claibourne, Union County, Ohio, enacted in accordance with a comprehensive plan and the provision of Chapter 519, Ohio Revised Code, dividing the Township into zones and districts, encouraging, regulating and restricting therein the location, construction, reconstruction, alteration and use of structures and land; promoting the orderly development of residential, business, industrial, recreational, and public areas; providing for adequate light, air and convenience of access to property by regulating the use of land and buildings and the bulk of structures in relationship to surrounding properties; limiting congestion in the public rights-of-way; providing the compatibility of different land uses and the most appropriate use of land; providing for the administration of this resolution as provided hereafter, and prescribing penalties for the violation of the provisions in this resolution or any amendment thereto. All for the purpose of protecting the public health, safety, and general welfare and for the repeal thereof.

Therefore, be it resolved by the Board of Trustees of the Township of Claibourne, Union County, Ohio.

Article I Title, Interpretation, and Enactment

Section 100 **Title.** This Resolution shall be known and may be cited to as the “Zoning Resolution of the Township of Claibourne, Union County, Ohio.”

Section 101 **Use of Land or Buildings for Agricultural Purposes Not Affected.** The use of land or buildings for agricultural purposes are not affected by this Resolution and no zoning certificate shall be required for any such building or structure or use of land. Residential dwellings do require a permit however.

Section 110 **Provisions of Resolution Declared to Be the Minimum Requirements.** In their interpretation and application, the provisions of this Resolution shall be held to be minimum requirements, adopted for the promotion of the public health, safety, and the general welfare. Whenever the requirements of this Resolution conflict with the requirements of any other lawfully adopted rules, regulations, resolutions, or deed restrictions, the most restrictive, or that imposing the higher standards shall govern.

Section 120 **Separability Clause.** Should any section or provision of this Resolution be declared by the courts to be unconstitutional or invalid, such decision shall not affect the validity of the Resolution as a whole or any part thereof other than the part so declared to be unconstitutional or invalid.

Section 130 **Replacement of Existing Resolutions, Effective Date.** All existing Resolution shall, upon adoption of this Resolution, be replaced by this Resolution and this Resolution shall have full force and effect. This Resolution shall become effective from and after the date of its approval and adoption, as provided by law.

Article II

Definitions

Interpretation of Terms or Words. For the purpose of this Resolution, certain terms or words used herein shall be interpreted as follows:

1. The word “person” includes a firm, association, organization, partnership, trust, company, or corporation as well as an individual.
2. The present tense includes the future tense, the singular number includes the plural, and the plural number includes the singular.
3. The word “shall” is a mandatory requirement, the word “may” is a permissive requirement, and the word “should” is a preferred requirement.
4. The words “used” or “occupied” include the words “intended, designed, or arranged to be used or occupied.”
5. The word “lot” includes the words “plot” or “parcel”.

Accessory Use or Structure. A use or structure on the same lot with, and of a nature customarily incidental and subordinate to, the principal use or structure.

Adult Entertainment Facilities. A facility having a significant portion of its function as adult entertainment which includes the following listed categories:

1. **Adult Bookstore.** An establishment having as a substantial or significant portion of its stock in trade, books, magazines, and other periodicals which are distinguished or characterized by their emphasis on matter depicting or relating to “specified sexual activities” or “specified anatomical areas” as herein defined or an establishment with a segment or section devoted to the sale or display of such material.
2. **Adult Booth.** Any area of a sexually oriented business establishment or tattoo parlor set off from the remainder of such establishment by one or more walls or other dividers or partitions and used to show, play, or otherwise demonstrate any adult materials or to view any live performance that is distinguished or characterized by an emphasis on the exposure, depiction, or description of “specified anatomical areas” or the conduct or simulation of “specified sexual activities.”

3. Adult Material. Any of the following whether new or used:
 - a. Books, magazines, periodicals, or other printed matter, or digitally stored materials that are distinguished or characterized by an emphasis on the exposure, depiction, or description of “specified anatomical areas” or the conduct or simulation of “specified sexual activities.”
 - b. Films, motion pictures, video or audio cassettes, slides, computer displays, or other visual representations or recording of any kind that are distinguished or characterized by an emphasis on the exposure, depiction, or description of “specified anatomical areas” or the conduct or simulation of “specified sexual activities.”
 - c. Instruments, novelties, devices, or paraphernalia that are designed for use in connection with “specified sexual activities” or that depict or describe the “specified anatomical areas.”
4. Adult Mini Motion Picture Theatre. A facility with a capacity for less than fifty (50) persons, used for presenting material distinguished or characterized by an emphasis on matter depicting, describing, or relating to “specified sexual activities” or “specified anatomical areas,” for observation by patrons therein.
5. Adult Motion Picture Theatre. A facility with a capacity of fifty (50) or more persons, used for presenting material distinguished or characterized by an emphasis on matter depicting, describing, or relating to “specified sexual activities” or “specified anatomical areas,” for observation by patrons therein.
6. Adult Entertainment Business. Any establishment involved in the sale or services or products characterized by the exposure or presentation of “specified anatomical areas” or physical contact of live males or females, and which is characterized by salacious conduct appealing to prurient interest for the observation or participation in by patrons. Services or products included within the scope of adult entertainment business are photography, dancing, reading, massage, and similar functions which utilize activities as specified above.

Agriculture. “Agriculture” shall include farming, dairying, pasturage, horticulture, viticulture, animal and poultry husbandry and the raising and/or sales of agricultural products.

Animal Feed Lot. Means a paved animal feeding or holding area or other lot, pen, yard, or other feeding or holding area where grass or other suitable vegetative cover is not maintained.

Aviation Field (Private). Any privately owned and operated, F.A.A. approved runway, landing area or other facility designed, used or intended to be used for the landing and taking off of aircraft, including all necessary taxiways, aircraft storage facilities and tie-down areas, hangers and other necessary buildings and open spaces.

Automotive Repair. The repair, rebuilding or reconditioning of motor vehicles or parts thereof, including collision services, painting and steam cleaning of vehicles.

Automotive Vehicle. A vehicle which is designed and manufactured to be self-propelling or self-moving upon the public highway. More specifically, as referred to in this Resolution, it includes: automobiles, trucks, tractors, and motorcycles.

Alterations, Structural. Any change in the supporting members of a building such as bearing walls, columns, beams, or girders.

Basement. A story all or partly underground but having at least one-half of its height below the average level of the adjoining ground.

Building. Any structure designed or intended for the support, enclosure, shelter, or protection of persons, animals, chattels, or property.

Building, Accessory. A subordinate building detached from, but located on the same lot as the principal building, the use of which is incidental and accessory to that of the main building or use.

Building, Height. The vertical distance measured from the average elevation of the proposed finished grade at the front of the building to the highest point of the roof for flat roofs, to the deck line of mansard roofs, and the mean height between eaves and ridge for gable, hip and gambrel roofs. Where a building is located on sloping terrain, the height may be measured from the average ground level of the grade at the building wall.

Building Principal. A building in which is conducted the main or principal use of the lot on which said building is situated.

Business, Convenience-Type Retail. Retail businesses whose market area is the neighborhood or part of the community, which provides convenience-type goods and personal services for the daily needs of the people within the residential area. Uses include, but need not be limited to, drugstores, beauty salons, barber shops, carry-outs, dry cleaning and laundry facilities, supermarkets, etc.

Business, Drive In. Any business, structure or premise which is designed primarily to serve occupants of motor vehicles without the occupants having to leave the vehicle.

Business, Service. Any profit making activity which renders primarily services to the public or to other commercial or industrial enterprises. Some retail sales may be involved in connection with the service rendered.

Business, Shopping-Type Retail. A retail or service business which supplies a wide variety of comparison goods and services to consumers in a market area that includes the community or an area greater than a community. Examples of shopping-type businesses are furniture stores, automobile sales and services and clothing shops.

Clinic. A place used for the care, diagnosis and treatment of sick, ailing, infirm, or injured persons, and those who are in need of medical and surgical attention, but who are not provided with board or room or kept overnight on the premises.

Club. A building or portion thereof or premises owned or operated by a person for a social, literary, political, educational, fraternal or recreational purpose primarily for the exclusive use of members and their guests.

Conditional Use. A use permitted within a district other than a principally permitted use, requiring a conditional use permit and approval of the Board of Zoning Appeals. Conditional uses permitted in each district are listed in the Official Schedule of District Regulations.

Conditional Use Permit. A permit issued by the Zoning Inspector upon approval by the Board of Zoning Appeals to allow a use other than a principally permitted use to be established within the district.

Density. A unit of measurement; the number of dwelling units per acre of land.

1. **Gross Density** – The number of dwelling units per acre of the total land to be developed.
2. **Net Density** – The number of dwelling units per acre of land when the acreage involved includes only the land devoted to residential uses.

Dwelling. Any building or structure which is wholly or partly used or intended to be used for living or sleeping by one or more human occupants.

Dwelling Unit. Space, within a dwelling, comprising living, dining, sleeping room or rooms, storage closets, as well as space and equipment for cooking, bathing, and toilet facilities, all used by only one family and its household employees.

Dwelling, Single-Family. A dwelling, except a manufactured home not permanently sited or a mobile home, consisting of single dwelling unit only, separated from other dwelling units by open space.

Dwelling, Multi-Family. A dwelling, except a manufactured home not permanently sited or a mobile home, consisting of two or more dwelling units including condominiums with varying arrangements of entrances and party walls.

Dwelling, Industrialized Unit. Pursuant to ORC 3781.06 (C) (3), as they may be amended or replaced from time to time, “industrialized unit” means a building unit or assembly of closed construction fabricated in an off-site facility, that is substantially self-sufficient as a unit or as part of a greater structure, and that requires transportation to the site of intended use. “Industrialized unit” includes unit installs on the site as independent units, as part of a group of units, or incorporated with standard construction methods to form a completed structural entity. “Industrialized unit” does not include a manufactured home as defined herein or a mobile home as defined herein.

Dwelling, Manufactured Home Pursuant to ORC 3781.06 (C) (4), as they may be amended or replaced from time to time, “manufactured home” means a building unit or assembly of closed construction that is

fabricated in an off-site facility and constructed in conformance with the federal construction and safety standards established by the secretary of housing and urban development pursuant to the “Manufactured Housing Construction and Safety Standards Act of 1974,” 88 Stat. 700, 42 U.S.C.A. 5401, 5403, and that has a permanent label or tag affixed to it, as specified in 42 U.S.C.A. 5415, as they may be amended or replaced from time to time, certifying compliance with all applicable federal construction and safety standards.

Dwelling, Manufactured Home (Permanently Sited). Pursuant to ORC 3781.06 (C) (6), as they may be amended or replaced from time to time, “permanently sited manufactured home” means a manufactured home that meets all of the following criteria:

- a) The structure is affixed to a permanent foundation and is connected to appropriate facilities. “Permanent foundation” means permanent masonry, concrete, or a footing or foundation approved by the Ohio Department of Commerce pursuant to ORC 4781, as they may be amended or replaced from time to time, to which a manufactured home may be affixed; and,
- b) The structure, excluding any addition, has a width of at least twenty-two feet at one point, a length of at least twenty-two feet at one point, and a total living area, excluding garages, porches, or attachments, of at least nine hundred square feet; and,
- c) The structure has a minimum 3:12 residential roof pitch, conventional residential siding, and a six-inch minimum eave overhang, including appropriate guttering; and,
- d) The structure was manufactured after January 1, 1995; and,
- e) The structure is not located in a manufactured home park as defined herein.

Dwelling, Mobile Home. Pursuant to ORC 4501.01 (O), as they may be amended or replaced from time to time, “mobile home” means a building unit or assembly of closed construction that is fabricated in an off-site facility, is more than thirty-five body feet in length or, when erected on site, is three hundred twenty or more square feet, is built on a permanent chassis, is transportable in one or more sections, and does not qualify as a manufactured home as defined herein or as an industrialized unit as defined herein.

Dwelling, Rooming House (Boarding House, Lodging House, Dormitory). A dwelling or part thereof, other than a hotel, motel, or restaurant where meals and/or lodging are provided for compensation,

for three or more unrelated persons where no cooking or dining facilities are provided in the individual rooms.

Essential Services. The erection, construction, alteration or maintenance, by public utilities or municipal or other governmental agencies, of underground gas, electrical, water transmission, or distribution systems, collection, communication, supply or disposal systems or sites, including poles, wires, mains, drains, sewers, pipes, traffic signals, hydrants, or other similar equipment and accessories in connection therewith which are reasonably necessary for the furnishing of adequate service by such public utilities or municipal or other governmental agencies or for the public health or safety or general welfare, but not including buildings.

Family. One or more related persons occupying a single dwelling unit.

Farm. A farm is an area of land on which an agricultural product is produced that derives an income and has a cash marketable value for the landowner or tenant.

Farm Pond. A body of water smaller than a lake, located on a farm.

Floor Area of a Residential Building. The sum of the gross horizontal area of the several floors of a residential building, excluding basement floor areas not devoted to residential use and attached garages, but including the area of roofed porches and roofed terraces. All dimensions shall be measured between interior faces of walls.

Floor Area of a Non-Residential Building (To be used in calculating parking requirements). The floor area of the specified use excluding stairs, washrooms, elevator shafts, maintenance shafts and rooms.

Floor Area, Useable. Measurement of usable floor area shall be the sum of the horizontal areas of the several floors of the building, measured from the interior faces of the exterior walls.

Food Processing. The preparation, storage or processing of food products. Examples of these activities include bakeries, dairies, canneries, meat processing plants and similar activities.

Gasoline Service Station. Buildings and premises where gasoline, oil, grease, batteries, tires, and automobile accessories may be supplied and dispensed at retail.

Hazardous Wastes. Means those substances which, singly or in combination, pose a significant present or potential threat or hazard to human health or to the environment, and which, singly or in combination, require special handling, processing, or disposal, because they are or may be flammable, explosive, reactive, corrosive, toxic, infectious, carcinogenic, bioconcentrative, or persistent in nature, potentially lethal, or an irritant or strong sensitizer.

Home Occupation. An occupation conducted in a dwelling unit, provided that: No more than one person other than members of the family residing on the premises shall be engaged in such occupation. The uses of the dwelling unit for the home occupation shall be clearly incidental and subordinate to its use for residential purposes by its occupants, and not more than thirty-five percent of floor area of the dwelling unit shall be used in the conduct of the home occupation. There shall be no change in the outside appearance of the building or premises, or other visible evidence of the conduct of such home occupation other than one sign, not exceeding four square feet in area, non-illuminated and mounted flat against the wall of the principal building. No traffic shall be generated by such occupation in greater volume than would normally be expected in such a residential area and any need for parking generated by the conduct of such home occupation shall meet the off-street parking requirements as specified in this Resolution.

Junk. “Junk” means old scrap, copper, brass, rope, rags, trash, waste, batteries, paper, rubber, junked, dismantled, or wrecked automobiles or parts thereof, iron, steel, and other old or scrap ferrous or non-ferrous materials.

Junk Yard. “Junk Yard” means an establishment or place of business which is maintained or operated, or any other land used, for the purpose of storing, keeping, buying, or selling junk, or for the maintenance or operation of an automobile graveyard. It shall also include scrap metal processing facilities which are located within one thousand feet of the nearest edge of the right-of-way of a highway or street.

Kennel. Any lot or premise on which dogs, cats or other household pets are boarded, bred or exchanged for monetary compensation.

Lake. A body of fresh water of considerable size, surrounded by land.

Loading, Space, Off-Street. Space logically and conveniently located for bulk pickups and deliveries, scaled to delivery vehicles expected to be used, and accessible to such vehicles when required off-street parking spaces are filled. Required off-street loading space is not to be included as off-street parking space in computation of required off-street parking space. All off-street loading spaces shall be located totally outside of any street or alley right-of-way.

Lot. For purposes of this Resolution, a lot is a parcel of land of at least sufficient size to meet minimum zoning requirements for use, coverage, and area, and to provide such yards and other spaces as are herein required. Such lot shall have frontage on an improved public street or road, and may consist of:

1. A single lot of record;
2. A portion of a lot of record;
3. A combination of complete lots of record, of complete lots of record and portions of lots of record, or of portions of lots of record.
4. A parcel of land described by metes and bounds.

However, in no case of diversion or combination shall any residential lot or parcel be created which does not meet the requirements of this Resolution.

Lot Coverage. The ratio of enclosed ground floor area of all buildings on a lot to the horizontally projected area of the lot, expressed as a percentage.

Lot Frontage. The front of a lot shall be construed to be the portion at the street or road. For the purpose of determining yard requirements on corner lots and through lots, all sides of a lot adjacent to streets or roads shall be considered frontage, and yards shall be provided as indicated under “Yard” in this section.

Lot, Minimum Area of. The area of a lot is computed exclusive of any portion of the right-of-way of any public or private street or road.

Lot Measurements. A lot shall be measured as follows:

Depth. The distance between the mid-points of straight lines connecting the foremost points of the side lot lines in front and rearmost points of the side lot lines in the rear. No lot less than twenty (20) acres shall have an average depth which is more than three (3) times its average width. Further, all lots of twenty (20) acres or more shall be exempt from this ratio.

Width. The distance between straight lines connecting front and rear lot lines at each side of the lot, measured at the building setback line.

Lot of Record. A lot which is part of a subdivision recorded in the office of the County Recorder, or a lot or parcel described by metes and bounds, the description of which has been so recorded.

Lot Types. Terminology used in this Resolution with reference to corner lots, interior lots and through lots is as follows:

1. **Corner Lot.** A lot located at the intersection of two or more streets. A lot abutting on a curved street or streets shall be considered a corner lot if straight lines drawn from the foremost points of the side lot lines to the foremost point of the lot meet at an interior angle of less than one hundred thirty-five degrees.
2. **Interior Lot.** A lot with only one frontage on a street.
3. **Through Lot.** A lot other than a corner lot with frontage on more than one street or road. Through lots abutting two streets or roads may be referred to as double frontage lots.
4. **Reversed Frontage Lot.** A lot on which frontage is at right angles to the general pattern in the area. A reversed frontage lot may also be a corner lot.

Manufacturing, Heavy. Manufacturing, processing, assembling, storing, testing, and similar industrial uses which are generally major operations and extensive in character; require large sites, open storage and service areas, extensive services and facilities, ready access to regional transportation; and normally generate some nuisances such as smoke, noise, dust, glare, air pollution, odor, but not beyond the district boundary to any large extent.

Manufacturing, Light. Manufacturing or other industrial uses which are usually controlled operations; relatively clean, quiet, and free of objectionable or hazardous elements such as smoke, noise, odor or dust; operate and store within enclosed structures; and generate little industrial traffic and no major nuisances.

Mining, Commercial Quarries, Sand and Gravel Pits. Any mining, quarrying or processing of limestone, clay, sand and gravel or other mineral resources. Also referred to as mineral extraction.

Manufactured or Mobile Home Park. Any site, or tract of land under single ownership, upon which three or more manufactured or mobile homes used for habitation are parked, either free of charge or for revenue purposes; including any roadway building, structure, vehicle, or enclosure used or intended for use as a part of the facilities of such park. This definition does not include individual lots for the purpose of installation of manufacturing or mobile homes.

Medical Marijuana Related Definitions.

- a) **Cultivate.** Means to grow, harvest, package, and transport medical marijuana pursuant to ORC 3796, as they may be amended or replaced from time to time.
- b) **Cultivator.** Means an entity that has been issued a certificate of operation by the State of Ohio to grow, harvest, package, and transport medical marijuana as permitted under ORC 3796, as they may be amended or replaced from time to time.
- c) **Dispensary.** Means an entity licensed pursuant to ORC 3796, as they may be amended or replaced from time to time, and any rules promulgated thereunder to sell medical marijuana to qualifying patients and caregivers.
- d) **Dispense.** Means the delivery of medical marijuana to a patient or the patient's registered caregiver that is packaged in a suitable container appropriately labeled for subsequent administration to or use by a patient as permitted by Ohio law in accordance with Ohio law.
- e) **Manufacture.** Means the process of converting harvested plant material into marijuana extract by physical or chemical means for use as an ingredient in a medical marijuana product.

- f) **Marihuana**. Has the same meaning as defined in ROC 3719.01, as amended from time to time.
- g) **Marijuana**. Has the same meaning as defined in ORC 3796.01, as amended from time to time.

- h) **Medical Marijuana**. Has the same meaning as defined in ORC 3796.01, as amended from time to time.

- i) **Medical Marijuana Entity**. Means a medical marijuana cultivator, processor, dispensary, or testing laboratory licensed by the State of Ohio.

- j) **Medical Marijuana Processor**. Means an entity that has been issued a certificate of operation by the State of Ohio to manufacture medical marijuana products.

- k) **Testing Laboratory**. Means an independent laboratory located in Ohio that has been issued a certificate of operation by the State of Ohio to have custody and use of controlled substances for scientific and medical purposes and for purposes of instruction, research, or analysis.

Motor Vehicle Salvage Facility. Means any establishment or place of business which is maintained, used, or operated for buying or selling wrecked, scrapped, ruined, or dismantled motor vehicles or motor vehicle parts.

Non-Conformities. A building, structure or use of land existing at the time of enactment of this Resolution and which does not conform to the regulations of the district or zone in which it is situated.

Nursery, Nursing Home. A home or facility for the care and treatment of babies, children, pensioners or elderly people.

Nursery, (Greenhouse) Tree and Plant. A place where young trees or other plants are raised for transplanting and/or for sale.

Offices. Quasi-commercial uses which may often be transitional between retail business and/or manufacturing and residential uses. Office business generally accommodates such occupations as administrative, professional, accounting, clerical, drafting, etc.

Institutional offices of a charitable, philanthropic, financial or religious or educational nature are also included in this classification.

Open Space. An area substantially open to the sky which may be on the same lot with a building. The area may include, along with the natural environmental features, water areas, swimming pools and tennis courts and other recreational facilities that the zoning commission deems permissive. Streets, parking areas, structures for habitation, and the like shall not be included.

Orchards. An area of land devoted to the cultivation and sale of fruit trees and the sale of the fruit therefrom.

Parking Space, Off-Street. For the purpose of this Resolution, an off-street parking space shall consist of an area adequate for parking an automobile with room for opening doors on both sides, together with properly related access to a public street or alley and maneuvering room, but shall be located totally outside of any street or road or alley right-of-way.

Personal Services. Any enterprise conducted for gain which primarily offers services to the general public such as shoe repair, watch and clock repair, barber shops, beauty shops and similar activities.

Pond. A water impoundment made by constructing a dam or an embankment or by excavating a pit or dugout. Ponds constructed by the first method are referred to as embankment ponds, and those constructed by the second method are referred to as excavated ponds.

Printing and Publishing. Any business which is engaged in the printing and/or publishing of newspapers, magazines, brochures, business cards and similar activities either for profit or non-profit.

Public Service Facility. The erection, construction, alteration, operation, or maintenance of buildings, power plants, substations, water treatment plant or pump station, sewage disposal plant or pump station, sewage disposal plant or pump station, communications facilities and/or equipment, electrical, gas, water and sewerage service and other similar public service structures or facilities whether publicly or privately owned; but excluding sanitary landfills.

Public Uses. Public parks, schools, administrative and cultural buildings and structures, not including public land or buildings devoted

solely to the storage and maintenance of equipment and materials and public service facilities.

Quasi-public Use. Churches, and other facilities of an educational religious, charitable, philanthropic, or non-profit nature.

Recreation, Commercial. Any business which is operated as a recreational enterprise, either publicly or privately owned, for profit. Examples include, but are not limited to: golf courses, bowling alleys, swimming pools, tourist attractions, etc.

Recreation, Non-Commercial. Any business which is operated as a recreational enterprise, either publicly or privately owned, for non-profit. Examples include, but are not limited to: fishing areas, parks, archery ranges, etc.

Recreational Vehicle. A vehicle type unit primarily designed as temporary living quarters for recreational, camping, or travel use only, which either has its own motive power or is mounted on or drawn by another vehicle. The basic entities are: travel trailer, camping trailer, truck camper, and motor home.

Recreational Vehicle Park. A parcel of land upon which two or more recreational vehicle sites are located, established, or maintained for occupancy by recreational vehicles of the general public as temporary living quarters for recreation or vacation purposes.

Recreational Vehicle Site. A plot of ground within a recreational vehicle park intended for the accommodation of either a recreational vehicle, tent, or other individual camping unit on a temporary basis.

Research, Development and Testing. Establishments, structures, facilities and areas devoted to research, product development and scientific testing whether in connection with the development of new products, the discovery of causes of product failure or malfunction, and specifically including without limitation the conduct of research, development and testing concerning: automotive, vehicular and other forms of transportation; engines, power products and equipment; production equipment; any and all other processes related to any of the foregoing; an improved highway facilities for vehicular traffic.

Right-of-Way. A strip of land taken or dedicated for use as a public way. In addition to the roadway, it normally incorporates the curbs,

lawn strips, sidewalks, lighting, and drainage facilities, and may include special features required by the topography or treatment (such as grade separation, landscape areas, viaducts, and bridges).

Salvage Motor Vehicle. Means any motor vehicle which is in a wrecked, dismantled, or worn out condition, or unfit for operation as a motor vehicle.

Sanitary Landfill. Means a land disposal site employing a method of disposing of solid wastes on land in a manner intended to minimize environmental hazards by spreading the solid wastes in thin layers, compacting the solid wastes to the smallest practical volume, and applying and compacting cover material daily.

Seat. For purposes of determining the number of off-street parking spaces for certain uses, the number of seats is the number of seating units installed or indicated, or each twenty-four (24) lineal inches of benches, pews, or space for loose chairs.

Setback Line. A line established by the Zoning Resolution generally parallel with and measured from the lot line, defining the limits of a yard in which no building, other than accessory building, or structure may be located above ground, except as may be provided in said code.

Sewers, Central or Group. An approved sewage disposal system which provides a collection network and disposal system and central sewage treatment facility for a single development, community, or region.

Sewers, On-Site. A septic tank or similar installation on an individual lot which utilizes an aerobic bacteriological process or equally satisfactory process for the elimination of sewage and provides for the proper and safe disposal of the effluent, subject to the approval of health and sanitation officials having jurisdiction.

Sidewalk. That portion of the road right-of-way outside the roadway, which is improved for the use of pedestrian traffic.

Sign. Any device designated to inform or attract the attention of persons not on the premises on which the sign is located.

1. **Sign, On-Premises.** Any sign related to a business or profession conducted, or a commodity or service sold or offered upon the premises where such sign is located.

2. Sign, Off-Premises. Any sign unrelated to a business or profession conducted or to a commodity or service sold or offered upon the premises where such sign is located.
3. Sign, Illuminated. Any sign illuminated by electricity, gas, or other artificial light including reflection or phosphorescent light.
4. Sign, Lighting Device. Any light, string of lights, or group of lights located or arranged so as to cast illumination on a sign.
5. Sign, Ground. Means a display sign supported by uprights or braces in or upon the ground surface.
6. Sign, Marquee. Means a display sign attached to or hung from a marquee, canopy or other covered structure projecting from and supported by the building and extending beyond the building wall, building line or street lot line.
7. Sign, Pole. Means any sign which is erected on a pole or poles, which is wholly or partially independent of any building for support.
8. Sign, Projecting. Means a display sign which is attached directly to the building wall and which extends more than fifteen inches from the face of the wall.
9. Sign, Roof. Means a display sign which is erected, constructed and maintained above the roof of the building.
10. Sign, Temporary. Means a display sign, banner or other advertising device constructed on cloth, canvas, fabric or other light temporary material, with or without a structural frame, intended for a limited period of display, including decorative displays for holidays or public demonstrations.
11. Sign, Wall. Means a display sign which is painted on or attached directly to the building wall and which extends not more than fifteen inches from the face of the wall.

Service Station. Any building, structure, or land used for the dispensing and sale at retail of any automobile fuels, oils, or accessories, including lubrication of automobiles and replacement or installation of minor parts and accessories but not including major repair work.

Small Wind Projects less than 5 MW:

- Accessory Structures. Structures such as sheds, storage sheds, pool houses, unattached garages, and barns.
- Anemometer. An instrument that measures the force and direction of the wind.
- Clear Fall Zone. An area surrounding the wind turbine unit into which the turbine and/or turbine components might fall due to the inclement weather, poor maintenance, faulty construction methods, or any other condition causing turbine failure that shall remain unobstructed and confined within the property lines of the primary parcel where the turbine is located. The purpose of the zone being that if the turbine should fall or otherwise become damaged, the falling structure will be confined to the primary parcel and will not intrude onto a neighboring property.
- Cowling. A streamlined removable cover that encloses the turbine's nacelle.
- Decibel. A unit of relative loudness equal to ten times the common logarithm of the ratio of two readings. For sound, the decibel scale runs from zero for the least perceptible sound to 130 for sound that causes pain.
- Nacelle. Sits atop the tower and contains the essential mechanical components of the turbine to which the rotor is attached.
- Primary Structure. For each property, the structure that one or more persons occupy the majority of time on that property for either business or personal reasons. Primary structures include structures such as residences, commercial buildings, hospitals, and day care facilities. Primary structures exclude structures such as hunting sheds, storage sheds, pool houses, unattached garages, and barns.
- Professional Engineer (PE). A qualified individual who is licensed as a Professional Engineer in the State of Ohio.
- Megawatt (MW). A unit of power, equal to one million watts.

- Small Wind Project. Any wind project less than 5MW which includes the wind turbine generator and anemometer.
- Wind Power Turbine Owner. The person, persons, or entity who owns the Wind Turbine structure.
- Wind Power Turbine Tower. The support structure to which the turbine and rotor are attached.
- Wind Power Turbine Tower Height. The distance from the rotor blade at its highest point to the top surface of the ground at the Wind Power Generating Facility (WPGF) foundation.

Solid Wastes. Means such unwanted residual solid or semisolid material as results from industrial, commercial, agricultural, and community operations, excluding earth or material from construction, mining, or demolition operations, and slag and other substances which are not harmful or inimical to public health, and includes, but is not limited to, garbage, combustible and non-combustible material, street dirt, and debris. For purposes of this definition, “material from construction operations” and “material from demolition operators” are those items affixed to the structure being constructed or demolished, such as brick, stone, glass, wallboard, framing and finishing lumber, roofing materials, plumbing fixtures, wiring, and insulation material.

Story. That part of a building between the surface of a floor and the ceiling immediately above.

Structure. Anything constructed or erected, the use of which requires location on the ground, or attachment to something having a fixed location on the ground. Among other things, structures include buildings, mobile homes, walls, fences and billboards.

Supply Yards. A commercial establishment storing and offering for sale building supplies, steel supplies, coal, heavy equipment, feed and grain, and similar goods.

Swimming Pool. A pool, lake, pond or open tank containing at least 1.5 feet of water at any point and maintained by the owner or manager. Farm ponds are exempt from this definition.

1. Private. Exclusively used without paying an additional charge for admission by the residents and guests of a single household, a multi-family development, or a community, the members and guests of a club, or the patrons of a motel or hotel; and accessory use.
2. Community. Operated with a charge for admission; a primary use.

Toxic or Hazardous Material. Means any substance or mixture by physical characteristic such as flammability, corrosivity, toxicity, reactivity, or infectious characteristics as to pose, a significant or potential hazard to water supplies or human health if such substances were discharged to land or waters of the community or township.

Transient Lodgings. A building in which lodging or boarding and lodging are provided and offered to the public for compensation. As such, it is open to the public in contradistinction to a boarding house, rooming house, lodging house, or dormitory which is herein separately defined. Examples include: hotel, motel, and apartment hotel.

Transport Terminals. Any business, structure or premise which primarily receives or distributes goods.

Transportation, Director of. The Director of the Ohio Department of Transportation.

Use. The specific purposes for which land or a building is designated, arranged, intended, or for which it is or may be occupied or maintained.

Variance. A variance is a modification of the strict terms of the relevant regulations where such modification will not be contrary to the public interest and where owing to conditions peculiar to the property and not the result of the action of the applicant, a literal enforcement of the regulations would result in unnecessary and undue hardship.

Veterinary Animal Hospital or Clinic. A place used for the care, grooming, diagnosis, and treatment of sick, ailing, infirm, or injured animals, and those who are in need of medical or surgical attention, and may include overnight accommodations on the premises for the treatment, observation and/or recuperation. It may also include boarding that is incidental to the primary activity.

Very Low Density Residential. Very low density residential land use refers to farm housing units and isolated residential developments not

requiring a major plat under the County's Subdivision Regulations. (A major plat consists of 6 or more lots.)

Wholesale and Warehousing. Business establishments that generally store and sell commodities in large quantities or by the piece to retailers, jobbers, other wholesale establishments, or manufacturing establishments.

Yard. A required open space other than a court unoccupied and unobstructed by any structure or portion of a structure from three (3) feet above the general ground level of the graded lot upward; provided, accessories, ornaments, and furniture may be permitted in any yard, subject to height limitations and requirements limiting obstruction of visibility.

1. **Yard, Front.** A yard extending between side lot lines across the front of a lot and from the front lot line to the front of the principal building.
2. **Yard, Rear.** A yard extending between side lot lines across the rear of a lot and from the rear lot line to the rear of the principal building.
3. **Yard, Side.** A yard extending from the principal building to the side lot line on both sides of the principal building between the lines establishing the front and rear yards.

Zoning Certificate. A document issued by the Zoning Inspector authorizing the occupancy or use of a building or structure or the actual use of lots or land in accordance with the previously issued Zoning Permit.

Zoning Permit. A document issued by the zoning inspector authorizing the use of lots, structures, uses of land and structures, and the characteristics of the uses.

Article III

Enforcement

Section 300

Zoning Permits Required. No building, or other structure, shall be erected, moved, added to, structurally altered, nor shall any building, structure or land be established or changed in use without a permit therefore, issued by the Zoning Inspector. Said permits shall be obtained before any county permits are obtained. Zoning permits shall be issued only in conformity with the provisions of this Resolution unless the Zoning Inspector receives a written order from the Board of Zoning Appeals deciding an appeal, conditional use, or variance as provided by this Resolution.

Section 301

Contents of Application for Zoning Permit. The application for zoning permit shall be signed by the owner or applicant attesting to the truth and exactness of all information supplied on the application. Each application shall clearly state that the permit shall expire and may be revoked if work has not begun within six months or substantially completed within one and one-half (1 ½) years. At a minimum, the application shall contain the following information:

1. Name, address, and telephone number of applicant;
2. Legal description of the property;
3. Existing use;
4. Proposed use;
5. Zoning district;
6. Plans in duplicate drawn to scale, showing the actual dimensions and the shape of the lot to be build upon; the exact size and location of existing buildings on the lot, if any, and the location and dimensions of the proposed building(s) or alteration;
7. Building heights;
8. Number of off-street parking spaces or loading berths;
9. Number of dwelling units;
10. Such other matters as may be necessary to determine conformance with, and provide for the enforcement of this Resolution.

Section 302

Approval of Zoning Permit. Within ten (10) days after the receipt of an application, the Zoning Inspector shall either approve or disapprove the application in conformance with the provision of this Resolution. All zoning permits shall, however, be conditional upon the commencement of work within six months. One copy of the plans shall be returned to the applicant by the Zoning Inspector, after the Zoning Inspector shall have marked, such copy either as approved or disapproved and attested to same by his signature on such copy. One

copy of plans, similarly marked, shall be retained by the Zoning Inspector. The Zoning Inspector shall issue a placard, to be posted in a conspicuous place on the property in question, attesting to the fact that the use or alteration is in conformance with the provisions of this Resolution.

Section 303

Submission to Director of Transportation. Before any zoning permit is issued affecting any land within three-hundred (300) feet of the centerline of a proposed new highway or a highway for which changes are proposed as described in the certification to local officials by the Director of Transportation or any land within a radius of five hundred (500) feet from the point of intersection of said centerline with any public road or highway, the Zoning Inspector shall give notice, by registered mail to the Director of Transportation, that he shall not issue a zoning permit for one hundred twenty (120) days from the date the notice is received by the Director of Transportation. If the Director of Transportation notifies the Zoning Inspector that he shall proceed to acquire the land needed, then the Zoning Inspector shall refuse to issue the zoning permit. If the Director of Transportation notifies the Zoning Inspector that acquisition at this time is not in the public interest or upon the expiration of the one-hundred twenty (120) day period or any extension thereof agreed upon by the Director of Transportation and the property owner, the Zoning Inspector shall, if the application is in conformance with all provisions of this Resolution issue the zoning permit.

Section 304

Expiration of Zoning Permit. If the work described in any zoning permit has not begun within six months from the date of issuance thereof, said permit shall expire; it shall be revoked by the Zoning Inspector; and written notice thereof shall be given to the persons affected. If the work described in any zoning permit has not been substantially completed within one and one-half (1 ½) years of the date of issuance thereof, said permit shall expire and be revoked by the Zoning Inspector, and written notice thereof shall be given to the persons affected, together with notice that further work as described in the cancelled permit shall not proceed unless and until a new zoning permit has been obtained or extension granted. Extensions, if granted, shall be in six months increments, not to exceed one and one-half years.

Section 310

Certificate of Occupancy. It shall be unlawful to use or occupy or permit the use of occupancy of any building or premises or both, or part thereof thereafter created, erected, changed, converted, or wholly or partly altered or enlarged in its use or structure until a certificate of

occupancy shall have been issued therefore by the Zoning Inspector stating that the proposed use of the building or land conforms to the requirements of this Resolution.

- Section 311** **Temporary Certificate of Occupancy.** A temporary certificate of occupancy may be issued by the Zoning Inspector for a period not exceeding six months during alterations or partial occupancy of a building pending its completion.
- Section 312** **Record of Zoning Permits and Certificates of Occupancy.** The Zoning Inspector shall maintain a record of all zoning permits and certificates of occupancy and copies shall be furnished upon request to any person.
- Section 320** **Failure to Obtain a Zoning Permit or Certificate of Occupancy.** Failure to obtain a zoning permit or certificate of occupancy shall be a violation of this Resolution and punishable under Section 350 of this Resolution.
- Section 330** **Construction and Use to be as Provided in Applications, Plans, Permits, and Certificates.** Zoning permits or certificates of occupancy issued on the basis of plans and applications approved by the Zoning Inspector authorize only the use and arrangement, set forth in such approved plans and applications or amendments thereto, and no other use, arrangement, or construction. Use, arrangement, or construction contrary to that authorized shall be deemed a violation of this Resolution and punishable as provided in Section 350 of this Resolution.
- Section 340** **Complaints Regarding Violations.** Whenever a violation of this Resolution occurs, or is alleged to have occurred, any person may file a written complaint. Such complaint stating fully the causes and basis thereof shall be filed with the Zoning Inspector. The Zoning Inspector shall record properly such complaint, immediately investigate and take action thereon as provided by this Resolution.
- Section 350** **Penalties for Violation.** Violation of the provisions of this Resolution or failure to comply with any of its requirements, including violations of conditions and safeguards established in various sections of this Resolution shall constitute a minor misdemeanor. Any person who violates this Resolution or fails to comply with any of its requirements shall upon conviction thereof be fined not more than five hundred (500) dollars for each offense and in addition shall pay all costs and expenses involved in the case. Such sum may be recovered in a court of

jurisdiction in Union County by the legal representative of the township, in the name of the township and for the use thereof. Each day such violation continues after receipt of a violation notice, shall be considered a separate offense. The owner or tenant of any building structure, premises, or part thereof, and any architect, builder, contractor, agent, or other person who commits, participates in, assists in, or maintains such violation may each be found guilty of a separate offense and suffer the penalties herein provided. Nothing herein contained shall prevent the Board of Township Trustees from taking such other lawful action as is necessary to prevent or remedy any violation.

Section 360

Section 360 Schedule of Fees, Charges, and Expenses. The Board of Township Trustees shall by Resolution establish a schedule of fees, charges, and expenses and a collection procedure for zoning permits, amendments, appeals, variances, conditional use permits, plan approvals, and other matters pertaining to the administration and enforcement of this Resolution requiring investigation, inspections, legal advertising, postage, and other expenses. The schedule of fees shall be posted in the office of the Township Trustees, and may be altered or amended only by the Township Trustees. Until all applicable fees, charges, and expenses have been paid in full, no action shall be taken on any application or appeal.

Article IV

Non-Conformities

Section 400

Intent. Within the districts established by this Resolution or future amendments that may later be adopted there exists lots, uses of land, structures, and uses of structures and land in combination which were lawful before this Resolution was passed or amended, but which would be prohibited, regulated, or restricted under the terms of this Resolution or future amendments. It is the intent of this Resolution to permit these non-conformities to continue until they are removed or discontinued. It is further the intent of this Resolution that non-conformities shall not be enlarged upon, expanded or extended, nor be used as grounds for adding other structures or uses prohibited elsewhere in the same district.

Section 410

Incompatibility of Non-Conformities. Non-conformities are declared by this Resolution to be incompatible with permitted uses in the districts in which such use is located. A non-conforming use of land, or a non-conforming use of a structure and land in combination shall not be extended or enlarged after passage of this Resolution by attachment on a building or premises of additional signs intended to be seen from off the premises, or by the addition of other uses of a nature which would be generally prohibited in the district in which such use is located.

Section 420

Avoidance of Undue Hardship. To avoid undue hardship, nothing in this Resolution shall be deemed to require a change in the plans, construction, or designated use of any building on which actual construction, was lawfully begun prior to the effective date of adoption or amendment of this Resolution and upon which actual building construction has been carried on diligently. Actual construction is hereby defined to include the placing of construction materials in permanent position and fastened in a permanent manner. Where demolition or removal of an existing building has been substantially begun preparatory to rebuilding, such demolition or removal shall be deemed to be actual construction, provided that the work shall be carried out diligently.

Section 430

Single Non-Conforming Lots of Record. In any district in which single-family dwellings are permitted, a single-family dwelling and customary accessory buildings may be erected on any single lot of record at effective date of adoption or amendment of this Resolution notwithstanding limitations imposed by other provisions of this Resolution. Such lot must be in separate ownership and not of continuous frontage with other lots in the same ownership. This provision shall apply even though such lot fails to meet the requirements

for area or width, or both, that are generally applicable in the district, provided that yard dimensions and requirements other than those applying to area or width, or both, of the lot shall conform to the regulations for the district in which such lot is located. Variances of requirements listed in Article 9 and 10 of this Resolution other than lot area or lot width shall be obtained only through action of the Board of Zoning Appeals as provided in Section 540 through 549.

Section 431

Non-conforming Lots of Record in Combination. If two or more lots or a combination of lots and portions of lots with continuous frontage in single ownership are of record at the time of passage or amendment of this Resolution and if all or part of the lots with no buildings do not meet the requirements established for lot width and area, the lands involved shall be considered to be an undivided parcel for the purposes of this Resolution and no portion of said parcel shall be used or sold in a manner which diminishes compliance with lot width and area requirements established by this Resolution, nor shall any division of any parcel be made which creates a lot with a width or area below the requirements stated in this Resolution.

Section 440

Non-Conforming Uses of Land. Where, at the time of adoption of this Resolution lawful uses of land exist which would not be permitted by the regulations imposed by this Resolution, the uses may be continued so long as they remain otherwise lawful, provided:

1. No such non-conforming uses shall be enlarged or increased nor extended to occupy a greater area of land than was occupied at the effective date of adoption or amendment of this Resolution.
2. No such non-conforming uses shall be moved in whole or in part to any portion of the lot or parcel other than that occupied by such uses at the effective date of adoption or amendment of this Resolution.
3. If any such non-conforming uses of land are discontinued or abandoned for more than two (2) years (except when government action impedes access to the premises), any subsequent use of such land shall conform to the regulations specified by this Resolution for the district in which such land is located.
4. No additional structure not conforming to the requirements of this Resolution shall be erected in connection with such non-conforming use of land.

Section 450

Non-Conforming Structures. Where a lawful structure exists at the effective date of adoption or amendment of this Resolution by reason of restrictions on area, lot coverage, height, yards, its location on the lot, bulk, or other requirements concerning the structure, such structure may be continued so long as it remains otherwise lawful, subject to the following provisions:

1. No such non-conforming structure may be enlarged or altered in a way which increases its non-conformity, but any structure or portion thereof may be altered to decrease its non-conformity;
2. Should such non-conforming structure or non-conforming portion of structure be destroyed by fire or an Act of God, it may after approval by the Board of Zoning Appeals, be reconstructed as it previously existed. All remaining debris shall be cleared away and disposed of properly within two months of the time of destruction.
3. Should such structure be moved for any reason for any distance whatever, it shall thereafter conform to the regulations for the district in which it is moved.

Section 456

Non-Conforming Uses of Structures or of Structures and Land in Combination. If a lawful use involving individual structures, or of a structure and land in combination, exists at the effective date of adoption or amendment of this Resolution that would not be allowed in the district under the terms of this Resolution, the lawful use may be continued so long as it remains otherwise lawful, subject to the following provisions:

1. No existing structure devoted to a use not permitted by this Resolution in the district in which it is located shall be enlarged, extended, constructed, moved, or structurally altered except in changing the use of the structure to a use permitted in the district in which it is located.
2. Any non-conforming use may be extended throughout any parts of a building which were manifestly arranged or designed for such use at the time of adoption or amendment of this Resolution; but no such use shall be extended to occupy any land outside such building;
3. If no structural alterations are made, any non-conforming use of a structure or structure and land, may upon appeal to the Board of Zoning Appeals, be changed to another non-conforming use

provided that the Board of Zoning Appeals shall find that the proposed use is equally appropriate or more appropriate to the district than the existing non-conforming use. In permitting such change, the Board of Zoning appeals may require appropriate conditions and safeguards in accord with other provisions of this Resolution;

4. Any structure, or structure and land in combination, in or on which a non-conforming use is superseded by a permitted use, shall thereafter conform to the regulations for the district, and the non-conforming use may not thereafter be resumed;
5. When a non-conforming use of a structure, or structure and land in combination is discontinued or abandoned for more than two (2) years (except when government action impedes access to the premises), the structure and land in combination shall not thereafter be used except in conformity with the regulations of the district in which it is located;
6. Where non-conforming use status applies to a structure and land in combination, removal or destruction of the structure shall eliminate the non-conforming status of the land except as stated in Section 450 paragraph 2.

Section 470

Repairs and Maintenance. On any non-conforming structure or portion of a structure containing a non-conforming use, work may be done on ordinary repairs, or on repair or replacement of non-bearing walls, fixtures, wiring, or plumbing, provided that the cubic content existing when it became non-conforming shall not be increased. Nothing in this section shall be deemed to prevent the strengthening or restoring to a safe condition of any building or part thereof declared to be unsafe by any official charged with protecting the public safety, upon order of such official.

Section 480

Uses Under Conditional Use Provisions Not Non-Conforming Uses. Any use which is permitted as a conditional use in a district under the terms of this Resolution shall not be deemed a non-conforming use in such district, but shall without further action be considered a conforming use.

Article V Administration

Section 500 Office of Zoning Inspector Created. A Zoning Inspector designated by the Board of Township Trustees shall administer and enforce this Resolution. He may be provided with the assistance of such other persons as the Trustees may direct.

Section 501 Duties of the Zoning Inspector. For the purpose of this Resolution, the Zoning Inspector shall have the following duties:

1. Upon finding that any of the provisions of this Resolution are being violated, he shall notify in writing the person responsible for such violation(s), ordering the action necessary to correct such violation;
2. Order discontinuance of illegal uses of land, buildings, or structures;
3. Order removal of illegal buildings or structures or illegal additions or structural alterations;
4. Order discontinuance of any illegal work being done;
5. Take any other action authorized by this Resolution to ensure compliance with or to present violation(s) of this Resolution. This may include the issuance of and action on zoning and certificate of occupancy permits and such similar administrative duties as are permissible under the law.

Section 510 Proceedings of Zoning Commission. The Commission shall adopt rules necessary to the conduct of its affairs in keeping with the provisions of this Resolution. Meetings shall be held at the call of the chairman and at other times as the Commission may determine. All meetings shall be open to the public. The Commission shall keep minutes of its proceedings showing the vote of each member upon each question, or if absent or failing to vote, indicating such fact, and shall keep records of its examinations and other official actions all of which shall be a public record and be immediately filed in the office of the Commission.

Section 511 Duties of Zoning Commission. For the purposes of this Resolution the Commission shall have the following duties:

1. Initiate proposed amendments to this Resolution;

2. Review all proposed amendments to this Resolution;

Section 520

Board of Zoning Appeals Created. A Board of Zoning Appeals is hereby created, which shall consist of five (5) members to be appointed by the Board of Township Trustees each for a term of five (5) years, except that the initial appointments shall be one (1), two (2), three (3), four (4) and five (5) year terms. Each member shall be a resident of the township. Members of the Board may be removed from office by the Trustees for cause upon written charges and after public hearing. Vacancies shall be filled by appointment by the Trustees for the unexpired term of the member affected.

Section 521

Proceedings of the Board of Zoning Appeals. The Board shall adopt rules necessary to the conduct of its affairs in keeping with the provisions of this Resolution. Meetings shall be held at the call of the chairman and at such other times as the Board may determine. The chairman, or in his absence the acting chairman, may administer oaths and compel the attendance of witnesses. All meetings shall be open to the public. The Board shall keep minutes of its proceedings, showing the vote of each member upon each question, or if absent or failing to vote, indicating such fact, and shall keep records of its examinations and other official actions, all of which shall be a public record and be immediately filed in the office of the Board.

Section 522

Duties of the Board of Zoning Appeals. In exercising its duties, the Board may, as long as such action is in conformity with the terms of this Resolution, reverse or affirm, wholly or partly, or modify the order, requirement, decision, or determination appealed from and make such order, requirement, decision, or determination as ought to be made, and to that end shall have the powers of the Zoning Inspector from whom the appeal is taken. A concurring vote of at least three (3) members of the Board shall be necessary to reverse any order, requirement, decision, or determination of the Zoning Inspector, or to decide in favor of the applicant on any matter upon which it is required to pass under this resolution or to effect any variation in the application of this Resolution. For the purpose of this Resolution the Board has the following specific responsibilities:

1. To hear and decide appeals where it is alleged there is an error in any order, requirement, decision, interpretation, or determination made by the Zoning Inspector;

2. To authorize such variances from the terms of this Resolution as will not be contrary to the public interest, where, owing to the special conditions, a literal enforcement of this Resolution will result in unnecessary hardship, and so that the spirit of this Resolution shall be observed and substantial justice done;
3. To grant conditional use permits as specified in the Office Schedule of District Regulations and under the conditions specified in Article 9 and such additional safeguards as will uphold the intent of this Resolution.

Section 530

Duties of Zoning Inspector, Board of Zoning Appeals, Legislative Authority and Courts on Matters of Appeal. It is the intent of this Resolution that all questions of interpretation and enforcement shall be first presented to the Zoning Inspector, and that such questions shall be presented to the Board only on appeal from the decision of the Zoning Inspector, and that recourse from the decisions of the Board shall be to the courts as provided by law. It is further the intent of this Resolution that the duties of the Township Trustees in connection with this Resolution shall not include hearing and deciding questions of interpretation and enforcement that may arise. The procedure for deciding such questions shall be as stated in this section and this Resolution. Under this resolution the Township Trustees shall have only the duties of considering and adopting or rejecting proposed amendments or the repeal of this Resolution as provided by law; and of establishing a schedule of fees and charges as stated in Section 360 of this resolution. Nothing in this Resolution shall be interpreted to prevent any official of the Township from appealing a decision of the Board to the courts as provided in the Ohio Revised Code. Any such appeal shall be made within ten (10) days of the Board's written decision.

Section 540

Procedure and Requirements for Appeals and Variances. Appeals and variances shall conform to the procedures and requirements of Section 541-549, inclusive, of this Resolution. As specified in Section 522, the Board of Zoning Appeals has appellate jurisdiction relative to appeals and variances.

Section 541

Appeals. Appeals to the Board of Zoning Appeals concerning interpretation or administration of this Resolution may be taken by any person aggrieved or by any office or bureau of the legislative authority of the Township affected by a decision of the Zoning Inspector. Such appeal shall be taken within twenty (20) days after the decision by filing, with the zoning Inspector and with the Board of Zoning Appeals, a notice of appeal specifying the grounds upon which the appeal is being

taken. The Zoning Inspector shall transmit to the Board of Zoning Appeals all the papers constituting the record upon which the action appealed from was taken.

Section 542

Stay of Proceedings. An appeal stays all proceedings in furtherance of the action appealed from, unless the Zoning Inspector from whom the appeal is taken certifies to the Board of Zoning Appeals after the notice of appeal is filed with him that by reason of facts stated in the application, a stay would in his opinion, cause imminent peril to life and property. In such case, proceedings shall not be stayed other than by a restraining order which may be granted by the Board of Zoning Appeals or by a court of record on application, on notice to the Zoning Inspector from whom the appeal is taken and on due cause shown.

Section 543

Variances. The Board of Zoning Appeals may authorize upon appeal in specific cases such variance from the terms of this Resolution as will not be contrary to the public interest where, owing to special conditions, a literal enforcement of the provisions of this Resolution would result in unnecessary hardship. No non-conforming use of neighboring lands, structures, or buildings in the same district and no permitted or non-conforming use of lands, structures, or buildings in other districts shall be considered grounds for issuance of a variance. Variances shall not be granted on the grounds of convenience or profit, but only where strict application of the provisions of this Resolution would result in unnecessary hardship.

Section 544

Application and Standards for Variances. A variance from the terms of this Resolution shall not be granted by the Board of Zoning Appeals unless and until a written application for a variance is submitted to the Zoning Inspector and the Board of Zoning Appeals containing:

1. Name, address, and telephone number of applicants;
2. Legal description of property;
3. Description or nature of variance requested;
4. A narrative statement demonstrating that the requested variance conforms to the following standards;
 - a. That special conditions and circumstances exist which are peculiar to the land, structure, or building involved and which are not

- applicable to other lands, structures, or buildings in the same district;
- b. That a literal interpretation of the provisions of this Resolution would deprive the applicant of rights commonly enjoyed by other properties in the same district under the terms of this Resolution;
 - c. That special conditions and circumstances do not result from the actions of the applicant;
 - d. That granting the variance requested will not confer on the applicant any special privilege that is denied by this Resolution to other lands, structures, or buildings in the same district.

A variance shall not be granted unless the Board makes specific findings of fact based directly on the particular evidence presented to it, which support conclusions that the standards and conditions imposed by subsection 4 of this section have been met by the applicant.

Section 545

Supplementary Conditions and Safeguards. Under no circumstances shall the Board of Zoning Appeals grant an appeal or variance to allow a use not permissible under the terms of this Resolution in the District involved, or any use expressly or by implication prohibited by the terms of this Resolution in said district. In granting any appeal or variance, the Board of Zoning Appeals may prescribe appropriate conditions and safeguards in conforming with this Resolution. Violation of such conditions and safeguards, when made a part of the terms under which the appeal or variance is granted, shall be deemed a violation of this Resolution and punishable under Section 350 of this Resolution.

Section 546

Public Hearing by the Board of Zoning Appeals. The Board of Zoning Appeals shall hold a public hearing within twenty (20) days after the receipt of an application for an appeal or variance from the Zoning Inspector or an applicant.

Section 547

Notice of Public Hearing in Newspaper. Before holding the public hearing required in Section 546, notice of such hearing shall be given in one newspaper of general circulation in the township at least ten (10) days before the date of said hearing. The notice shall set forth the time and place of the public hearing, and the nature of the proposed appeal or variance.

- Section 548** **Notice to Parties in Interest.** Before holding the public hearing required in Section 546, written notice of such hearing shall be mailed by the chairman of the Board of Zoning Appeals, by first class mail, at least ten (10) days before the day of the hearing to all parties in interest. Parties of interest shall include, but not be limited to, property owners contiguous to and directly across the road (street) from the property concerned. The notice shall contain the same information as required of notices published in newspapers as specified in Section 547.
- Section 549** **Action by Board of Zoning Appeals.** Within thirty (30) days after the public hearing required in Section 547, the Board of Zoning Appeals shall either approve, approve with supplementary conditions as specified in Section 545, or disapprove the request for appeal or variance. The Board of Zoning Appeals shall further make a finding that the reasons set forth in the application justify the granting of the variance that will make possible a reasonable use of the land, building, or structure. Appeals from Board decisions shall be made in the manner specified in Section 530.
- Section 560** **Procedure and Requirements for Approval of Conditional Use Permits.** Conditional uses shall conform to the procedures and requirements of Section 561-568, inclusive of this Resolution.
- Section 561** **General.** It is recognized that an increasing number of new kinds of uses are appearing daily, and that many of these and some other more conventional uses possess characteristics of such unique and special nature relative to location, design, size, and method of operation, circulation, and public facilities that each specific use must be considered individually. These specific uses as they are conditionally permitted under the provisions of Article 9, shall follow the procedures and requirements set forth in Sections 562-568, inclusive.
- Section 562** **Contents of Application for Conditional Use Permit.** An application for a conditional use permit shall be filed with the Chairman of the Board of Zoning Appeals by at least one owner or lessee of property for which such conditional use is proposed. At a minimum the application shall contain the following information:
1. Name, address, and telephone number of applicant;
 2. Legal description of property;
 3. Description of existing use;

4. Zoning district;
5. Description of proposed conditional use;
6. A plan of the proposed site for the conditional use showing the location of all buildings, parking and loading areas, traffic access and traffic circulation, open spaces, landscaping, refuse and service areas, utilities, signs, yards, and such other information as the Board may require to determine if the proposed conditional use meets the intent and requirements of this Resolution.
7. A narrative statement evaluating the effects on adjoining property; the effect of such elements as noise, odor and fumes on adjoining property; a discussion of the general compatibility with adjacent and other properties in the district.

Section 563

General Standards Applicable to all Conditional Uses. The Board shall review the particular facts and circumstances of each proposed use in terms of the following standards and shall find adequate evidence showing that such use at the proposed location:

1. Is in fact a conditional use as established under the provisions of Article 9 and appears on the Official Schedule of District Regulations adopted by Section 910 for the zoning district involved;
2. Will be designed, constructed, operated, and maintained so as to be harmonious and appropriate in appearance with the existing or intended character of the general vicinity and that such use will not change the essential character of the same area;
3. Will not be hazardous or disturbing to existing or future neighboring uses;
4. Will be served adequately by essential public facilities and services such as highways, streets, police and fire protection, drainage structures, refuse disposal, water and sewer; or that the persons or agencies responsible for the establishment of the proposed use shall be able to provide adequately any such services;
5. Will not create excessive additional requirements at public cost for public facilities and services and will not be detrimental to the economic welfare of the community;

6. Will not involve uses, activities, processes, materials, equipment and conditions of operation that will be detrimental to property, or the general welfare by reason of excessive production of traffic, noise, smoke, fumes or odors;
7. Will have vehicular approaches to the property which shall be so designed as not to create an interference with traffic on surrounding public thoroughfares.

Section 565 **Supplementary Conditions and Safeguards.** In granting any conditional use, the Board may prescribe appropriate conditions and safeguards in conformity with this Resolution. Violations of such conditions and safeguards, when made a part of the terms under which the conditional use is granted, shall be deemed a violation of this Resolution and punishable under Section 350 of this Resolution.

Section 566 **Procedure for Hearing, Notice.** Upon receipt of the application for a conditional use permit specified in Section 562, the Board shall hold a public hearing, public notice in a newspaper, and give written notice to all parties in interest according to the procedures specified in Section 546 through 548.

Section 567 **Action by the Board of Zoning Appeals.** Within thirty (30) days after the public hearing required in Section 566, the Board shall either approve, approve with supplementary conditions as specified in Section 565, or disapprove the application as presented. If the application is approved or approved with modifications, the Board shall direct the Zoning Inspector to issue a conditional use permit listing the specific conditions specified by the Board for approval. If the application is disapproved by the Board, the applicant may seek relief through the Court of Common Pleas. Appeals from Board decisions shall be made in the manner specified in Section 530.

Section 568 **Expiration of Conditional Use Permit.** A conditional use permit shall be deemed to authorize only one particular conditional use, and said permit shall automatically expire if such conditionally permitted use has not been instituted or utilized within one (1) year of the date on which the permit was issued, or if for any reason such use shall cease for more than six (6) months. Change of ownership shall have no affect on the validity of the conditional use.

Article VI **Amendment**

Section 600 **Procedure for Amendment or District Changes.** This Resolution may be amended utilizing the procedures specified in Section 601-611, inclusive, of this Resolution.

Section 601 **General.** Whenever the public necessity, convenience, general welfare, or good zoning practices require, the Board of Township Trustees may by Resolution, after receipt of recommendation thereon from the Zoning Commission, and subject to procedures provided by law, amend, supplement, change or repeal the regulations, restrictions and boundaries or classification of property.

Section 602 **Initiation of Zoning Amendments.** Amendments to this Resolution may be initiated in one of the following ways:

1. By adoption of a motion by the Zoning Commission;
2. By adoption of a resolution by the Township Trustees;
3. By the filing of an application by at least one (1) owner or lessee of property within the area proposed to be changed or affected by said amendment.

Section 603 **Contents of Application.** Applications for amendments to the Official Zoning Map adopted as part of this Resolution by Section 700 shall contain at least the following information:

1. Name address, and telephone number of the applicant;
2. Present use;
3. Present zoning district;
4. Proposed use;
5. Proposed zoning district;
6. A vicinity map at a scale approved by the Zoning Inspector showing property lines, thoroughfares, existing and proposed zoning and such other items as the Zoning Inspector may require;

7. A list of all property owners and their addresses who are within, contiguous to, and directly across the rod (street) from the parcel(s) proposed to be rezoned and others that may have a substantial interest in the case, except that addresses need not be included where more than ten (ten) parcels are to be rezoned;
8. A fee as established by the Township Trustees, according to Section 360.

Section 604

Transmittal to Zoning Commission. Immediately after the adoption of a resolution by the Township Trustees or the filing of an application by at least one (1) owner or lessee of property, said resolution or application shall be transmitted to the Zoning Commission. The Zoning Commission shall comply with all the requirements of Chapter 519.12 of the Ohio Revised Code, as amended.

Section 605

Submission to Director of Transportation. Before any zoning amendment is approved effecting any land within three hundred (300) feet of the centerline of a proposed new highway or highway for which changes are proposed as described in the certification to local officials by the Director of Transportation, or within a radius of five hundred (500) feet from the point of intersection of said centerline with any public road or highway the Commission shall give notice, by registered mail or certified mail to the Director of Transportation. The Commission may proceed as required by law, however, the township trustees shall not approve the amendment for one hundred twenty (120) days from the date the notice is received by the Director of Transportation. If the Director of Transportation notifies the trustees that he shall proceed to acquire the land needed, then the trustees shall refuse to approve the rezoning. If the Director of Transportation notifies the trustees that acquisition at this time is not in the public interest or upon the expiration of the one hundred twenty (120) day period or any extension thereof agreed upon by the Director of Transportation and the property owner, the trustees shall proceed as required by law.

Section 606

Recommendation by Zoning Commission. After complying with all the requirements of Chapter 519.12 of the Ohio Revised Code, the Zoning Commission shall transmit its recommendation to the Township Trustees. The Zoning Commission may recommend that the amendment be granted as required, or it may recommend a modification of the amendment requested, or it may recommend that the amendment be denied.

- Section 607** **Public Hearing by Township Trustees.** Upon receipt of the recommendation from the Zoning Commission, the township trustees shall schedule a public hearing. Said hearing shall be not more than thirty (30) days from the receipt of the recommendation from the Zoning Commission.
- Section 608** **Notice of Public Hearing in Newspaper.** Notice of the public hearing required in Section 607 shall be given by the township trustees in compliance with all the requirements of Chapter 519.12 of the Ohio Revised Code as amended.
- Section 610** **Action by Township Trustees.** Within twenty (20) days after the public hearing required in Section 607, the Township Trustees shall either adopt or deny the recommendation of the Zoning Commission, or adopt some modification thereof by a simple majority vote.
- Section 611** **Effective Date and Referendum.** Such amendment adopted by the trustees shall become effective thirty (30) days after the date of adoption unless within thirty (30) days after the adoption of the amendment there is presented to the trustees a referendum petition, which is filed in accordance with Section 519.12 of the Ohio Revised Code as amended.

Article VII Provisions for Official Zoning Map

Section 700 **Official Zoning Map.** The districts established in Article 8 of this Resolution as shown on the Official Zoning map which, together with all explanatory matter thereon, are hereby adopted as part of this Resolution.

Section 710 **Identification of the Official Zoning Map.** The Official Zoning Map shall be identified by the signature of the chairman of the Board of Township Trustees and attested by the Clerk.

Section 720 **Interpretation of District Boundaries.** Where uncertainty exists with respect to the boundaries of any of the zoning districts as shown on the Official Zoning Map, the following rules shall apply:

1. Where district boundaries are indicated as approximately following the center lines of thoroughfares or highways, street lines, or highway right-of-way lines, such center lines, street lines, or highway right-of-way lines shall be construed to be such boundaries;
2. Where district boundaries are so indicated that they approximately follow the lot lines, such lot lines shall be construed to be such boundaries;
3. Where district boundaries are so indicated that they are approximately parallel to the center lines or street lines of streets, or the center lines or right-of-way lines of highways, such district boundaries shall be construed as being parallel thereto and such distance therefrom as indicated on the Official Zoning Map. If no distance is given, such dimensions shall be determined by the use of the scale shown on the Map.

Section 730 **Replacement of the Official Zoning Map.** In the event that for some reason the Official Zoning Map becomes damaged, destroyed, lost or difficult to interpret, the township trustees may by resolution adopt a new map which shall supersede the prior map. The new map may correct drafting errors in the prior map, but no such correction shall have the effect of amending the original map or any subsequent amendment thereof. The new map shall be identified by the signature of the chairman of the trustees, attested to by the township clerk, and bearing the following words: This is to certify that this Official zoning Map supersedes and replaces the Official Zoning Map adopted

____ (date) ____ as part of the Zoning Resolution of ____ Claibourne ____
Township, ____ Union ____ County, Ohio.

Article VIII Establishment and Purpose of Districts

Section 800 **Intent.** The following zoning districts are hereby established for the township. For the interpretation of this Resolution, the zoning districts have been formulated to realize the general purposes as set forth in the preamble of this Resolution. In addition, the specific purpose of each zoning district shall be as stated.

Section 810 **Rural District (U-1).** The purpose of the rural district is to provide land which is suitable or used for agriculture, conservation, very low density residential and public and quasi-public purpose. Very low density residential land use refers to farm housing units and isolated residential developments not requiring a major plat under the county's Subdivision Regulations. (A major plat consists of 6 or more lots). Some residential, commercial and industrial development may be permitted as Conditional Uses under Section 560. On-site water and sewer facilities are permitted, provided such facilities comply with the County Health Department regulations. Specific Permitted and Conditional Uses are listed on the Official Schedule of District Regulations.

Section 811 **Low Density Residential District (R-1).** The purpose of the low density residential district is to provide land for single family dwelling units not to exceed four dwellings per acre with a central sewerage system. This district shall also include land that is subdivided which requires a major plat under the County's Subdivision Regulations. (A major plat consists of 6 or more lots.) Specific Permitted and Conditional Uses are listed on the Official Schedule of District Regulations.

Section 812 **Medium Density Residential District (R-2).** The purpose of the R-2 district is to permit the establishment of medium density single-family dwellings not to exceed eight dwelling units per gross acre with a central sewerage system. This district is also designed to permit multi-family dwellings as a Conditional Use. Specific Permitted and Conditional Uses are listed on the Official Schedule of District Regulations.

Section 813 **High Density Residential District (R-3).** The purpose of the R-3 District is to permit the establishment of high density multi-family dwellings not to exceed sixteen (16) dwelling units per gross acre if a central sewerage system is available. Specific Permitted and Conditional Uses and minimum requirements are listed on the Official Schedule of District Regulations.

Section 814 **Local Business District (B-2)**. The purpose of the B-2 District is to provide land for retail and service businesses offering shopping and convenience-type goods and services. A variety of convenience and shopping-type activities may be available in addition to service businesses. Specific permitted and Conditional Uses are listed on the Official Schedule of District Regulations.

Section 815 **Light Manufacturing District (M-1)**. The purpose of the M-1 District is to provide land for manufacturing or industrial type facilities which are relatively clean, quiet and free of objectional elements such as noise, odor, smoke, etc.; operate mostly within enclosed structures; and do not generate as much traffic as would be found in a heavy manufacturing district. Specific Permitted and Conditional Uses are listed on the Official Schedule of District Regulations.

Article IX

District Regulations

Section 900

Compliance with Regulations. The regulations for each district set forth by this Resolution shall be minimum regulations and shall apply uniformly to each class or kind of structure or land, except as hereinafter provided; or as otherwise granted by the Board of Zoning Appeals.

1. No building, structure or land shall be used or occupied and no building or structure or part thereof shall be erected, constructed, reconstructed, moved or structurally altered except in conformity with all of the regulations herein specified for the district in which it is located.
2. No building or other structure shall be erected or altered:
 - a. to provide for greater height or bulk;
 - b. to accommodate or house a greater number of families;
 - c. to occupy a greater percentage of lot area;
 - d. to have narrower or smaller rear yards, front yards, side yards or other open spaces;
3. No yard or lot existing at the time of passage of this Resolution shall be reduced in dimension or area below the minimum requirements set forth herein. Yards or lots created after the effective date of this Resolution shall meet at least the minimum requirements set forth herein.

Section 910

Official Schedule of District Regulations. District regulations shall be as set forth in the Official Schedule of District Regulations hereby adopted and declared to be a part of this Resolution and in Article 10 of this Resolution, "Supplementary District Regulations."

OFFICIAL SCHEDULE OF DISTRICT REGULATIONS

<u>Zoning Districts</u> <i>(Symbols as used on the Official Zoning Map)</i>	<u>Permitted Uses</u> <i>(Accessory Uses and essential services are included)</i>	<u>Conditional Uses</u> <i>(Permitted upon Issuance of a Conditional Use Permit by the Board of Zoning Appeals)</i>
1	2	3
U-1 RURAL DISTRICT	Orchards, Agriculture, Very low density residential; Public & quasi-public uses; Nursery (greenhouse), tree & plant; Farm equipment sales & service;	Shopping-type retail; Convenience-type retail; Offices; Public service facility; Animal hospital, clinic, kennel; Home occupation; Commercial & non-commercial recreation; Service business; Craft & hobby shop; Mineral extraction; Light manufacturing; Signs & advertising structures; Manufactured home; Mobile home; Manufactured and/or Mobile Home Park; Food processing
R-1 LOW DENSITY RESIDENTIAL	Single-family dwelling; Public & quasi-public uses;	Public service facility; Home occupation; Service business; Personal services; Offices
R-2 MEDIUM DENSITY RESIDENTIAL	Single-family dwelling; Public & quasi-public uses;	Multi-family dwelling; Home occupation; Offices; Personal services; Service business;
R-3 HIGH DENSITY RESIDENTIAL	Multi-family dwelling; Single-family dwelling; Public & quasi-public uses;	Home occupation; Non-commercial recreation; Offices; Personal services; Service business; Public service facility;
B-2 LOCAL BUSINESS	Convenience & shopping-type retail; Offices; Service business; Drive-in business; Eating & drinking establishment; Commercial & non-commercial recreation; Personal services; Transient lodgings; Single & multi-family dwellings*; Club; Supply yard; Public & quasi-public uses; Food processing;	Wholesale & warehousing; Animal hospital, clinic, kennel; Printing & publishing; Public service facility; Signs & advertising structures;
M-1 LIGHT MANUFACTURING	Light manufacturing & related Offices; Wholesale & warehousing; Printing & publishing; Service business; Single-family dwelling*; Public & quasi-public uses;	Signs & advertising structures; Public service family;

OFFICIAL SCHEDULE OF DISTRICT REGULATIONS

ZONING DISTRICT	MINIMUM LOT SIZE			MAXIMUM PERCENTAGE OF LOT TO BE OCCUPIED	MINIMUM FLOOR AREA	MAXIMUM HEIGHT OF (Principal Buildings)		MINIMUM YARD DIMENSIONS (Ft.)			
	With on-site sewage treatment (sq ft per household)	With group or central sewage treatment (sq ft per household)	Width (feet)	Principal and Accessory Buildings	(Square Feet)	Stories	Feet	Front	Side Yards		Rear
	4	5	6	7	8	9	10	11	12	13	14
U-1	40,000	_____	150	25	1100*	2.5	35	50	20	40	30
R-1	40,000	_____	150	25	1,300	2.5	35	50	20	40	30
		10,800	80					(35)	(10)	(20)	(30)
R-2	40,000	_____	150	25	1,000	2.5	35	50*	20	40	30
		5,400	60					(35)	(10)	(20)	(30)
R-3	40,000	_____	150	30	850	2.5	35	50	20	40	30
			60		850	2.5	35	25	4	10	30
		5,400 (single) 2,700 (multi)	70		575	3	40	25	4	10	30
B-2	40,000	_____	150	100	none	3	40	0	**	**	0
M-1	40,000	_____	150	50	none	4	50	50	**	**	30**

OFFICIAL SCHEDULE OF DISTRICT REGULATIONS

ZONING DISTRICT	ACCESSORY BUILDINGS			MINIMUM (MANDATORY) OFF-STREET PARKING SPACE	MINIMUM (MANDATORY) OFF-STREET LOADING SPACE	SIGNS PERMITTED	OTHER PROVISIONS AND REQUIREMENTS
	Maximum Height (feet)	Minimum distance in feet to		One unit for each			Supplementary regulations prohibitions, notes etc.
		Side Lot Line	Rear Lot Line				
	15	16	17	18	19	20	21
U-1	20	10	10	See Article XI	See Article XI	See Article XII	*900 Square feet for mobile dwelling
R-1	15	10	10	"	"	"	Use parenthesis figures if central sewerage is used.
R-2	15	2	5	"	"	"	*Front setback for lots of record may be same as nearest adjoining residential structure.
R-3	15	2	5	"	"	"	
B-2	20	0	0	"	"	"	**Non-residential use cannot be conducted closer than 40 feet to any lot line of a residential structure. *Refer to R-1 or R-3 district as appropriate for regulations.
M-1	25	5	10	"	"	"	*Refer to R-1 district regs. **Non-residential use cannot be conducted closer than 40 feet to any lot line of a residential structure.

Article X **Supplementary District Regulations**

Section 1000 **General.** The purpose of supplementary district regulations is to set specific conditions for various uses, classification of uses or areas where problems may be encountered.

Section 1001 **Conversion of Dwellings to More Units.** A residence may be converted to accommodate an increased number of dwelling units provided:

1. The yard dimensions, including minimum lot width still meet the yard dimensions required by the zoning regulations for new structures in that district in which the dwelling is located;
2. The lot area per family equals the lot area requirements for new structures in that district;
3. The floor area per dwelling unit is not reduced to less than that which is required for new construction in that district.

Section 1002 **Private Swimming Pools.** A private swimming pool, not including farm ponds, shall be any pool, lake, or open tank not located within a completely enclosed building and containing or normally capable of containing water to a depth at any point greater than one and one-half (1 ½) feet. No such swimming pool, exclusive of portable swimming pools with a diameter less than 12 feet or with an area of less than 100 square feet shall be allowed in any residential district, except as an accessory use and unless it complies with the following conditions and requirements:

1. The pool is intended and is to be used solely for the enjoyment of the occupants of the principal use of the property on which it is located.
2. It may not be located, including any walks or paved areas or accessory structures adjacent thereto, closer than 10 feet to any property line of the property on which it is located.
3. The swimming pool or the entire property on which it is located shall be walled or fenced to prevent uncontrolled access by children from adjacent properties. Said fence or wall shall be not less than five (5) feet in height and maintained in good condition with a gate and lock.

Section 1003 **Community or Club Swimming Pools.** Community and club swimming pools are permitted as commercial or non-commercial

recreation in accordance with the Official Schedule of District Regulations, and shall comply with the following conditions and requirements:

1. The pool is intended solely for the enjoyment of the members and families and guests of members of the association or club under whose ownership or jurisdiction the pool is operated;
2. The pool and accessory structures thereto, including the areas used by the bathers, shall not be closer than thirty (30) feet to any property line;
3. The swimming pool and all of the area used by the bathers shall be walled or fenced to prevent uncontrolled access by children from the thoroughfare or adjacent properties. Said fence or wall shall not be less than five (5) feet in height and maintained in good condition.

Section 1004

Temporary Structures. Temporary structures, such as a manufactured home or mobile home, an existing dwelling, mobile offices, construction trailers, construction equipment and construction materials, used in conjunction with construction work on a lot require a zoning permit. The zoning inspector may approve a zoning permit for temporary structures, but such temporary structures shall be removed upon completion of the construction work or within 24 months upon issuance of an approved zoning permit, whichever occurs first.

Section 1005

Parking and Storage of Certain Vehicles. The following provisions and requirements shall pertain to the parking and storage of certain vehicles:

1. The parking or storage, within any district, of automotive vehicles without current license plates, for a period of more than thirty (30) days shall be prohibited unless such vehicle is stored in an enclosed garage or other accessory building;
2. The parking or storage, within any district, of a disabled automotive vehicle for a period of more than thirty (30) days shall be prohibited unless such vehicle is stored in an enclosed garage or other accessory buildings;
3. The parking or storage, within any district, of a junked, dismantled or wrecked automotive vehicle or parts thereof which is in public view

of any highway for a period of more than thirty (30) days shall be prohibited.

For purposes of this section, a junked, dismantled or wrecked automotive vehicle shall be one which is damaged, or no longer serviceable, to the extent that it is inoperable or is unsafe to operate upon the public highways.

This section shall not apply to properly licensed junk yards and motor vehicle salvage facilities which are regulated by appropriate sections of the Ohio Revised Code.

Section 1010 **Supplemental Yard and Height Regulations.** In addition to all yard regulations specified in the Official Schedule of District Regulations, and in other sections of this Resolution, the provisions of Sections 1011-1017, inclusive shall be used for interpretation and clarification.

Section 1011 **Setback Requirements for Corner Buildings.** On a corner lot the principal building and its accessory structures shall be required to have the same setback distance from all street right-of-way lines as required for the front yard in the district in which such structures are located.

Section 1012 **Visibility at Intersections.** On a corner lot in any district, nothing shall be erected, placed, planted, or allowed to grow in such a manner as to materially impede vision between a height of two and one-half (2 ½) and ten (10) feet above the center line grades of the intersecting streets or roads in the area bounded by the right-of-way lines of such corner lots and a line joining points along said street or road lines fifty (50) feet from the point of intersection.

Section 1014 **Yard Requirements for Multi-Family Dwellings.** Multi-family dwellings shall be considered as one (1) building for the purpose of determining front, side and rear yard requirements. The entire group as a unit shall require one (1) front, one (1) rear and two (2) side yards as specified for dwellings in the appropriate district. Each individual building shall meet all yard requirements for the appropriate district as though it were on an individual lot.

Section 1015 **Side and Rear Yard Requirements for Non-Residential Uses Abutting Residential Districts.** Non-residential buildings or uses shall not be located in or conducted closer than (40) feet to any lot line of a residential structure, except that the minimum yard requirements may be

reduced to fifty (50) percent of the requirement if acceptable landscaping or screening approved by the Zoning Inspector is provided.

- Section 1016** **Architectural Projections.** Open structures such as porches, canopies, balconies, platforms, carports, covered patios and similar architectural projections shall be considered parts of the building to which attached and shall not project into the required minimum front, side, or rear yard.
- Section 1017** **Exceptions to Height Regulations.** The height limitations contained in the Official Schedule of District Regulations do not apply to spires, belfries, cupolas, antennas, water tanks, ventilators, chimneys or other appurtenances usually required to be placed above the roof level and not intended for human occupancy except where the height of such structures will constitute a hazard.
- Section 1020** **Special Provisions for Commercial and Industrial Uses.** No commercial or industrial use as designated on the Official Schedule of District Regulations and defined herein nor any land or building in any district shall be used or occupied in any manner creating dangerous, injurious, noxious or otherwise objectionable conditions which could adversely affect the surrounding areas or adjoining premises, except that any use permitted by this Resolution may be undertaken and maintained if acceptable measures or safeguards to reduce dangerous and objectionable conditions to acceptable limits are taken.
- Section 1021** **Fire Hazards.** Any activity involving the permitted use or storage of flammable chemicals, petroleum products or explosive materials shall be protected by adequate fire-fighting and fire prevention equipment and by such safety devices as are normally used in the handling of any such material. Such hazards shall be kept removed from adjacent activities to a distance which is compatible with the potential danger involved.
- Section 1022** **Electrical Disturbance.** No activity shall emit electrical disturbance adversely affecting the operation of any equipment at any point other than that of the creator of such disturbance. The disturbance must be due solely to the creator and not due to defective wiring, equipment, etc., at the receiving point.
- Section 1024** **Water Pollution.** Water pollution as defined or determined by the County Board of Health or the Ohio Environmental Protection Agency shall be subject to corrective measures, requirements and regulations as established by the Board of Health or the Ohio E.P.A.

- Section 1025** **Mining, Mineral, Clay Sand and Gravel Extraction, Storage and Processing.** The extraction, storage and processing of minerals shall be conducted in accordance with the requirements of Sections 1026 through 1032 inclusive.
- Section 1026** **Distance from Residential Areas.** Mineral extraction, storage or processing shall not be conducted closer than 500 feet from any residential district, nor closer than 500 feet from any structure used for human occupancy in any other district.
- Section 1027** **Filing of Location Map.** The operator shall file with the Zoning Inspector a location map which clearly shows areas to be mined and the location of adjacent properties, roads and natural features.
- Section 1028** **Information on Operation.** The operator shall submit information on the anticipated depth of excavations and on depth and probable effect on the existing water table as coordinated with the Ohio Division of Water.
- Section 1029** **Restoration of Mined Area.** The operator may be required to file with the Board of Zoning Appeals a detailed plan for the restoration of the area to be mined which shall include the anticipated future use of the restored land.
- Section 1030** **Performance Bond.** The operator may be required to file with the Board of Township Trustees a bond, or other surety, payable to the township and conditioned on the faithful performance of all requirements contained in the approved restoration plan. The bond or other surety shall be released upon written certification of the zoning inspector that the restoration is complete and in compliance with the restoration plan.
- Section 1031** **Enforcement Provisions.** The zoning inspector, prior to the issuance of a zoning permit, may require the submission of statements and plans indicating the manner in which dangerous and objectionable elements involved in processing and in equipment operations are to be eliminated or reduced to acceptable limits and tolerances. The area being mined or that has been mined shall be posted with “No Trespassing” signs to discourage human injury to the general public.
- Section 1032** **Measurement Procedures.** Methods and procedures for the determination of the existence of any dangerous and objectionable elements shall conform to applicable standard measurement procedures

published by the American Standards Association, Inc., New York; the Manufacturing Chemists' Association, Inc., Washington D.C.; the United States Bureau of Mines and the Ohio Environmental Protection Agency.

Section 1035

General Conditions for Medical Marijuana Entities. In the interest of protecting the public health, safety, and general welfare, this section establishes zoning regulations that provide for State-authorized medical marijuana land uses consistent with ORC 519 and ORC 3796. ORC 519.21 and ORC 3796 allow regulation of the location of medical marijuana cultivators, processors, or dispensaries within the unincorporated area of the township.

1. Not an Agricultural Use. Medical marijuana is not considered an “agricultural” use pursuant to ORC 519.21 (D).
2. Zoning Districts. No medical marijuana cultivator, processor, or dispensary shall be located in a zoning district where it is not explicitly listed as a permitted or conditionally permitted use. Furthermore, no cultivator, processor, or dispensary shall be permitted as a home occupation.
3. Mobile Building Prohibited. No medical marijuana cultivator, processor, or dispensary shall be located within a mobile building.

Section 1040

Roadside Produce Stands. A building for the sale of home-grown produce may be located not less than twenty-five (25) feet from the highway right-of-way if it is a portable building. If portable, it shall be removed from its roadside location during the season that it is not in use as a roadside produce stand. A permanent structure for such use may be constructed, but shall be located not less than fifty (50) feet from the highway right-of-way line. Parking shall be provided off the highway right-of-way.

Section 1050

Storage of Toxic or Hazardous Materials. Except as exempted hereafter, the storage of toxic or hazardous materials, as determined by the Ohio Environmental Protection Agency, in quantities greater than 55 gallons liquid or 25 pounds dry weight for any one material shall be prohibited.

This section shall not apply to fuels stored in less than 1,100 gallon tanks that conform with the Ohio Fire Code for the purpose of heating buildings and located on site, nor to materials stored for one-site residential, industrial, commercial or agricultural purposes.

“Storage” when used in connection with this section, means the containment of hazardous materials, either on a temporary basis or for a period of years, in such a manner as not to constitute disposal of the materials.

Section 1055

Satellite Television Antennas. A satellite television antenna is an antenna the purpose of which is to receive television or radio signals from orbiting satellites.

A satellite television antenna shall not be located in any front yard. Nor shall it be located in any side yard closer to the building front setback line than the front of an adjoining residential structure, provided the adjoining residential structure is within 100 feet of the side lot line on which the antenna is proposed. Said antenna shall meet the minimum side and rear yard requirements for accessory structures and buildings.

Ground mounted satellite antennas in areas zoned residential shall not extend more than fifteen (15) feet above the ground, twenty (20) feet in all other zones. Roof mounted antennas shall be prohibited.

The satellite television antenna shall be constructed and anchored in such a manner to withstand wind forces up to 100 miles per hours.

Section 1060

Effective Screening of Junk Storage and/or Sales of Junk. Junk storage and/or sales of junk shall be effectively screened on all sides by means of walls, fences, or plantings. Walls or fences shall be a minimum of eight (8) feet in height with no advertising thereon. In lieu of such wall or fence, a strip of land not less than fifteen (15) feet in width, planted and maintained with an evergreen hedge or dense planting of evergreen shrubs not less than six (6) feet in height may be substituted. Storage of materials shall not exceed the height of the screening. Storage of junk shall not be located in any front or side yard.

Section 1065

Garage, Porch, Yard or Similar Type Sales. A resident may conduct a garage, porch, yard or similar type sale provided such sale does not exceed one such event during any six (6) months period. No sale shall exceed three (3) consecutive days in length. Parking shall be provided off the public highway right-of-way; and off neighboring property unless consent is obtained from the affected neighbor to do so. All signs advertising such sales shall be removed immediately after the sale has concluded its duration.

Section 1067

Mobile Trailers Prohibited for Business, Storage and Sign

Purposes. The use of a mobile home, tractor trailer, box car, or other similar type trailer, container or structure shall not be permitted as an office or business structure, storage facility or sign structure except as stated in Section 1004.

Section 1070

Small Wind Projects less than 5MW. Wind Projects of 5MW or more shall be required to submit an application with the Ohio Power Siting Board (OPSB) at the Public Utilities Commission of Ohio (PUCO) and are required to meet OPSB regulations. Small Wind Projects less than 5MW and used solely for Agriculture will be exempt from these zoning regulations as an Agricultural Use. Any proposed construction, erection, or siting of a small wind project less than 5MW including the wind turbine generator or anemometer or any parts thereof shall be a Permitted Use in all Claibourne Township Zoning Districts if the following conditions are met (both as Permitted and Conditional Use):

- A. The maximum height of any turbine shall be 125 ft. For purposes of this Resolution, maximum height shall be considered the total height of the turbine system including the tower, and the maximum vertical height of the turbine's blades. Maximum height therefore shall be calculated by measuring the length of a prop at maximum vertical rotation to the base of the tower.
- B. Setbacks: the following shall apply in regards to setbacks.
 - 1. Any turbine erected on a parcel of land shall be setback 1.25 times the height of the tower, and established "clear fall zone", from all road right-of-way lines, overhead utility lines, and neighboring property lines. A turbine shall be erected and placed in such a manner that if it were to fall, whatever direction the fall occurs would be contained solely on the property where the turbine is located.
- C. Maintenance
 - 1. Wind turbines must be maintained in good working order. The owner shall within 30 days of permanently ceasing operation of a wind turbine, provide written notice of abandonment to the Zoning Inspector. An unused wind turbine or small wind project may stand no longer than 12 months following abandonment. All costs associated with the demolition of the wind turbine and associated equipment shall be borne by the owner. A wind

turbine is considered abandoned when it ceases transmission of electricity for 90 consecutive days. Wind turbines that become inoperable for more than 12 months must be removed by the owner within 30 days of issuance of zoning violation. Removal includes removal of all apparatuses, supports, and or other hardware associated with the existing wind turbine.

D. Decibel Levels

1. Decibel levels shall not exceed those provided by the manufacturer as requested in II. Permits, C., 2., e.

E. Wiring and electrical apparatuses:

1. All wires and electrical apparatuses associated with the operation of a wind turbine unit shall be located underground and meet all applicable local, state, and federal codes including the County Building Regulations and Residential Building Code of Ohio.

F. Warning Signs:

1. Appropriate warning signs to address voltage shall be posted as required by the National Electric Code.

G. Building Permits:

1. All Small Wind Projects and parts thereof shall obtain all applicable Building Permits from the State of Ohio and County Building Regulations where required.

II. Zoning Permits

- A. A zoning permit shall be required before construction can commence on an individual wind turbine project.
- B. As part of the permit process, the applicant shall inquire with the County Building Regulations as to whether or not additional height restrictions are applicable due to the unit's location in relation to any local airports.
- C. Applicant shall then provide the Township Zoning Inspector with the following items and/or information when applying for a permit:

1. Location of all public and private airports in relation to the location of the wind turbine.
2. An report that shows:
 - a. The total size and height of the unit.
 - b. The total size and depth of the unit's foundation structure, as well as soil and bedrock data.
 - c. A list and or depiction of all safety measures that will be on the unit including anti-climb devices, grounding devices, and lightning protection, braking systems, guy wiring & anchors.
 - d. Data specifying the kilowatt size and generating capacity in kilowatts of the particular unit.
 - e. The maximum decibel level of the particular unit. This information shall be obtained from the manufacturer of the turbine unit.
 - f. Hazardous materials containment and disposal plan.
3. A site drawing showing the location of the unit in relation to existing structures on the property, roads and other public right-of-ways, overhead utility lines, and neighboring property lines.
4. Evidence of established setbacks of 1.25 times the height of the wind turbine and "clear fall zone."
5. A maintenance schedule as well as a dismantling plan that outlines how the unit will be dismantled shall be required as part of the permit.

Section 1075

General Conditions for Adult Entertainment Use. Adult Entertainment Facilities are conditionally permitted within the B-2 Local Business District only, and subject to conditions set forth in the Zoning Resolution Section 1075 and paragraphs 1-9 hereafter set forth.

1. No adult entertainment facility shall be established within one thousand (1,000) feet of any areas zoned for residential use.

2. No adult entertainment facility shall be established within a radius of one thousand five hundred (1,500) feet of any school, library, or teaching facility, whether public or private, governmental or commercial which school, library, or teaching facility is attended by persons under eighteen (18) years of age.
3. No adult entertainment facility shall be established within a radius of one thousand five hundred (1,500) feet of any park or recreational facility attended by persons under eighteen (18) years of age.
4. No adult entertainment facility shall be established within a radius of two thousand (2,000) feet of any other adult entertainment facility.
5. No adult entertainment facility shall be established within a radius of one thousand five hundred (1,500) feet of established church, synagogue, or permanently established place of religious services which is attended by persons under eighteen (18) years of age.
6. No advertisements, displays, or other promotional materials shall be shown or exhibited so as to be visible to the public from pedestrian sidewalks or walkways, or from other areas public or semi-public.
7. All building openings, entries, windows, etc. for adult uses shall be located, covered, or serviced in such a manner as to prevent a view into the interior from any public or semi-public area, sidewalk, or street. For new construction, the building shall be oriented so as to minimize any possibility of viewing the interior from public or semi-public areas.
8. No screens, loudspeakers, or sound equipment shall be used for adult motion picture theatres (enclosed or drive-in) that can be seen or discerned by the public from public or semi-public areas.
9. Off-street parking shall be provided in accordance with the standards for permitted use within the B-2 Local Business District.

Article XI

Off-Street Parking and Loading Requirements

Section 1100

General Requirements.

1. No building or structure shall be erected, substantially altered, or its use changed unless permanently maintained off-street parking and/or loading spaces have been provided in accordance with the provisions of this Resolution.
2. The provisions of this Article, except where there is a change of use, shall not apply to any existing building or structure.
3. Whenever a building or structure constructed after the effective date of this Resolution is changed or enlarged in floor area, number of employees, number of dwelling units, seating capacity, or otherwise to create a need for an increase in the number of existing parking spaces, additional parking spaces shall be provided on the basis of the enlargement or change. Whenever a building or structure existing prior to the effective date of this Resolution is enlarged to the extent of fifty (50) percent or more in floor area, number of employees, number of housing units, seating capacity or otherwise, said building or structure shall then and thereafter comply with the full parking requirements set forth herein.

Section 1110

Parking Space Dimensions. A parking space shall have minimum rectangular dimensions of not less than nine (9) feet in width and nineteen (19) feet in length for ninety (90) degree parking, nine (9) feet in width and twenty-three (23) feet in length for parallel parking, ten (10) feet in width and nineteen (19) feet in length for sixty (60) degree parking, and twelve (12) feet in width and nineteen (19) feet in length for forty-five (45) degree parking. All dimensions shall be exclusive of driveways, aisles and other circulation areas. The number of required off-street parking spaces is established in Section 1130 of this Resolution.

Section 1111

Loading Space Requirements and Dimensions. A loading space shall have minimum dimensions of not less than twelve (12) feet in width, fifty (50) feet in length, exclusive of driveways, aisles and other circulation areas and a height of clearance of not less than fifteen (15) feet. One off-street loading space shall be provided and maintained on the same lot requiring delivery of goods and having a modified gross floor area of up to five thousand (5,000) square feet. One loading space

shall be provided for each additional ten thousand (10,000) square feet or fraction thereof of ground floor area.

Section 1112 **Paving.** The required number of parking and loading spaces as set forth in Sections 1111 and 1130, together with driveways, aisles and other circulation areas, shall be improved with such material to provide a durable and dust-free surface.

Section 1116 **Location of Parking Spaces.** The following regulations shall govern the location of off-street parking spaces and areas;

1. Parking spaces for all detached residential uses shall be located on the same lot as the use which they are intended to serve;
2. Parking spaces for commercial, industrial or institutional uses shall be located not more than seven hundred (700) feet from the principal use;
3. Parking spaces for any apartments, or similar residential uses shall be located not more than three hundred (300) feet from the principal use.

Section 1117 **Screening and/or Landscaping.** Whenever a parking area is located in or adjacent to a residential district it shall be effectively screened on all sides which adjoin or face any property used for residential purposes, by an acceptable designed fence, or planting screen. Such fence or planting screen shall be not less than four (4) feet nor more than six (6) feet in height and shall be maintained in good condition. In the event that terrain or other natural features are such that the erection of such fence or planting screen will not serve the intended purpose, then no such fence or planting screen and landscaping shall be required.

Section 1119 **Minimum Distance and Setbacks.** No part of any parking area for more than ten (10) vehicles shall be closer than twenty (20) feet to any dwelling unit if located on an adjoining lot, unless separated by an acceptably designed screen. In no case shall any part of a parking area be closer than four (4) feet to any established road right-of-way.

Section 1120 **Joint Use.** Two or more non-residential uses may jointly provide and use parking spaces when their hours of operation do not normally overlap, provided that a written agreement approved by the Zoning Inspector shall be filed with the application for a zoning permit.

Section 1121 **Wheel Blocks.** Whenever a parking lot extends to a property line, wheel blocks or other suitable devices shall be installed to prevent any part of a parked vehicle from extending beyond the property line.

Section 1122 **Width of Driveway Aisle.** Driveways serving individual parking spaces shall be not less than twenty-five (25) feet wide for ninety (90) degree parking, twelve (12) feet wide for parallel parking, seventeen and one-half (17 ½) feet for sixty (60) degree parking and thirteen (13) feet for forty-five (45) degree parking.

Section 1130 **Parking Space Requirements.** For the purpose of this Resolution, the following parking space requirements shall apply:

<u>Type of Use</u>	<u>Parking Spaces Required</u>
Single Family or two family dwellings	Two for each unit
Apartments, or multi family dwellings	Two for each unit
Mobile Homes	Two for each unit
Outdoor swimming pools, public or community or club	One for each 5 persons capacity plus one for each 4 seats or one for each 30 sq. ft. floor area used for seating purposes whichever is greater
Retail establishments	One for each 250 sq. ft. of floor area
Offices, public or professional, administrative or service buildings	One for each 400 sq. ft. of floor area
All other types of businesses or commercial uses permitted	One for each 300 sq. ft. of floor area
Churches	One for each 5 seats
All types of manufacturing, storage and wholesale uses	One for every 2 employees on the largest shift for which the building is designed.

Section 1131 **General Interpretations.** In the interpretation of this Article, the following rules shall govern:

1. Parking spaces for other permitted or conditional uses not listed in this Article shall be determined by the Board upon an appeal from a decision of the Zoning Inspector.

2. Fractional numbers shall be increased to the next whole number.
3. When a reason for parking demand is unusually low, then the parking space provisions cited above may be reduced proportionately by the Board upon an appeal from a decision of the Zoning Inspector.

Article XII Signs

Section 1200 **Intent.** The purpose of this Article is to promote and protect the public health, welfare and safety by regulating existing and proposed outdoor advertising, outdoor advertising signs and outdoor signs of all types. It is intended to protect property values, create a more attractive economic and business climate, enhance and to protect the physical appearance of the township.

Section 1201 **Governmental Signs Excluded.** For the purpose of this Resolution “sign” does not include signs erected and maintained pursuant to and in discharge of any governmental function, or required by law, ordinance or governmental regulation.

Section 1202 **General Requirements for all Signs and Districts.** The regulations contained in this section shall apply to all signs and all use districts.

1. In no circumstance shall an illuminated sign or lighting device be placed or directed so as to permit the beams and illumination therefrom to be directed or beamed upon a public thoroughfare so as to cause glare or reflection that may constitute a traffic hazard or nuisance;
2. No sign shall be placed on the roof of any building;
3. No sign of any classification shall be installed, erected or attached in any form, shape or manner to a fire escape or any door or window giving access to any fire escape.
4. All billboard signs shall be plainly marked with the name of the person, firm or corporation responsible for maintaining the sign;
5. Should any sign be or become unsafe or be in danger of falling, the owner thereof or the person maintaining the same, shall upon receipt of written notice from the Zoning Inspector proceed at once to put such sign in a safe and secure condition or remove the sign;
6. No sign shall be placed in any public right-of-way except publicly owned signs, such as traffic control signs and directional signs. Signs directing and guiding traffic and parking on private property but bearing no advertising matter shall be permitted on any property.

Section 1203

Measurement of Sign Area. The surface area of a sign shall be computed as including the entire area within a regular geometric form or combinations of regular, geometric forms comprising all of the display area of the sign and including all of the elements of the matter displayed. Frames and structural members not being advertising matter shall not be included in computation of surface area.

Section 1210

Signs Permitted in all Districts not Requiring a Permit.

1. Signs advertising the sale, lease or rental of the premises upon which the sign is located, shall not exceed twelve (12) square feet in area, except in all residential districts where the area of the sign shall not be more than eight (8) square feet.
2. Professional name plates not to exceed two (2) feet by three (3) feet in area;
3. Signs denoting the name and address of the occupants of the premises, not to exceed four (4) square feet in area.

Section 1211

Signs Permitted in any District Requiring a Permit.

1. Any sign advertising a commercial enterprise, including real estate developers or subdividers in a district zoned rural or residential shall not exceed twelve (12) square feet in area and shall advertise only the names of the owners, trade names, products sold and/or the business or activity conducted on the premises where such sign is located.

Section 1212

Signs Permitted in Business and Manufacturing Districts Requiring a Permit.

The regulations set forth in this section shall apply to signs in the business and manufacturing districts and such shall require a permit.

1. In a business or manufacturing district, each business shall be permitted one flat or wall on-premises sign. Projection of wall signs shall not exceed two feet measured from the face of the main building. The area of all permanent on-premises signs for any single business enterprise may have an area equivalent to one and one-half (1 ½) square feet of sign area for each lineal foot of building width, or part of a building, occupied by such enterprise but shall not exceed a maximum area of one hundred (100) square feet.
2. In a business or manufacturing district, one off-premises sign with a total area not exceeding three hundred (300) square feet may be permitted at a single location. Off-premises signs visible to approaching traffic shall have a minimum spacing of not less than

two hundred (200) feet. Off-premises signs shall conform to all applicable yard and height regulations for the appropriate zoning district. Off-premises wall signs shall have all structural and supporting members concealed from view.

- Section 1220** **Temporary Signs.** Temporary signs not exceeding sixty-four (64) square feet in area, announcing special public or institutional events, the erection of a building, the architect, the builders, or contractors may be erected for a period of sixty (60) days plus the construction period. Such temporary signs shall conform to the general requirements listed in Section 1202, the setback requirements in Section 1240-1243 and, in addition, such other standards deemed necessary to accomplish the intent as stated in Section 1200.
- Section 1221** **Free Standing Signs.** Free-standing on premises signs not over thirty (30) feet in height, having a maximum total sign area of one hundred (100) square feet per display area and located not closer than fifteen (15) feet to any adjoining lot line may be placed to serve a business or group of business establishments. There shall be only one free-standing sign for each building, regardless of the number of businesses conducted in said building.
- Section 1222** **Wall Signs Pertaining to Non-Conforming Uses.** On-premises wall signs pertaining to a non-conforming use shall be permitted on the same premises of such use, provided the area of such sign does not exceed twelve (12) square feet.
- Section 1230** **Political Signs.** No political sign shall be posted in any place or in any manner that is destructive to public property upon posting or removal. No political sign shall be posted more than sixty (60) days before an election. All candidates for public office, their campaign committees, or other persons responsible for the posting on public property of campaign material shall remove such material within two (2) weeks following election day.
- Section 1240** **Sign Setback Requirements.** Except as modified in Sections 1241 & 1243, on-premises signs where permitted shall be set back from the established right-of-way line of any thoroughfare at least ten (10) feet. No off-premises sign shall be erected in front of the required setback line for the appropriate zoning district.

- Section 1241** **Increased Setback.** For every square foot by which any on-premises sign exceeds fifty (50) square feet, the setback shall be increased by one-half (1/2) foot but need not exceed one hundred (100) feet.
- Section 1243** **Setbacks for Public and Quasipublic Signs.** Real estate signs and bulletin boards for a church, school or any other public, religious or education institution may be erected not less than ten (10) feet from the established right-of-way line of any street or highway provided such sign or bulletin board does not obstruct traffic visibility at street or highway intersections.
- Section 1250** **Limitation.** For the purposes of this Resolution, outdoor advertising off-premises signs shall be classified as a business use and be permitted in all districts zoned for business, manufacturing, or lands used for agricultural purposes. In addition, regulation of signs along primary highways shall conform to the requirements of the Ohio Revised Code, Chapter 5316 and the regulations adopted pursuant thereto.
- Section 1251** **Violations.** In case any sign shall be installed, erected, constructed, or maintained in violation of any of the terms of this Resolution, the Zoning Inspector shall notify in writing the owner or lessee thereof to alter such sign so as to comply with this Resolution. Failure to comply shall be deemed a violation and shall be punishable under Section 350 of this Resolution.

Article XIII Manufactured and/or Mobile Home Parks & Manufactured and/or Mobile Homes Individually

Section 1300 **Intent.** It is the intent of this Article to regulate the location of, and to encourage, stabilize and protect the development of well-planned manufactured and/or mobile home parks if one is proposed.

Section 1310 **Approval Procedures.** Manufactured and/or mobile home parks shall be permitted only as a Conditional Use in the U-1 District and shall be developed according to the general standards and regulations stated and referenced in Article 13.

Section 1320 **General Standards for Manufactured and/or Mobile Home Parks.**
A new or expanded mobile home park shall:

1. be designed, constructed, operated and maintained so as to be harmonious and appropriate in appearance with the existing or intended character of the general vicinity and that such use will not change the essential character of the same area;
2. not be hazardous or detrimental to existing or future neighboring uses;
3. be served adequately by essential public facilities and services such as highways, police and fire protection, drainage, refuse disposal, etc.;
4. be consistent with the intent and purpose of this Resolution;
5. have vehicular approaches to the property which shall be so designed as not to create an interference with the traffic on surrounding public highways;
6. not result in the destruction, loss or damage of natural features of major importance.

Section 1330 **Manufactured and/or Mobile Home Park Requirements.**
Manufactured and/or mobile home parks shall be developed in accordance with the requirements of Chapter 37-1-27 of the Ohio Sanitary Code adopted by the Public Health Council under the authority of the Ohio Revised Code, Section 3733 and as amended.

Section 1341 **Manufactured (Not Permanently Sited) and/or Mobile Homes Individually.** The following requirements shall apply to manufactured

homes (not permanently sited) and/or mobile home dwellings that are placed upon an individual lot in any district where permitted:

1. Individual manufactured homes (not permanently sited) and/or mobile homes shall have, using accepted industry measurement standards, a minimum area of nine hundred (900) square feet of floor area.
2. The manufactured homes (not permanently sited) and/or mobile home's tongue(s), axle(s) and wheels shall be removed and the home shall be placed upon a permanent concrete foundation which is below the frost line and is in accordance with the County Auditor's current requirement for real estate tax purposes and which includes at least two tie-down rings.
3. The manufactured homes (not permanently sited) and/or mobile home shall be skirted entirely closing the bottom section, within ninety (90) days after its placement.

STREET

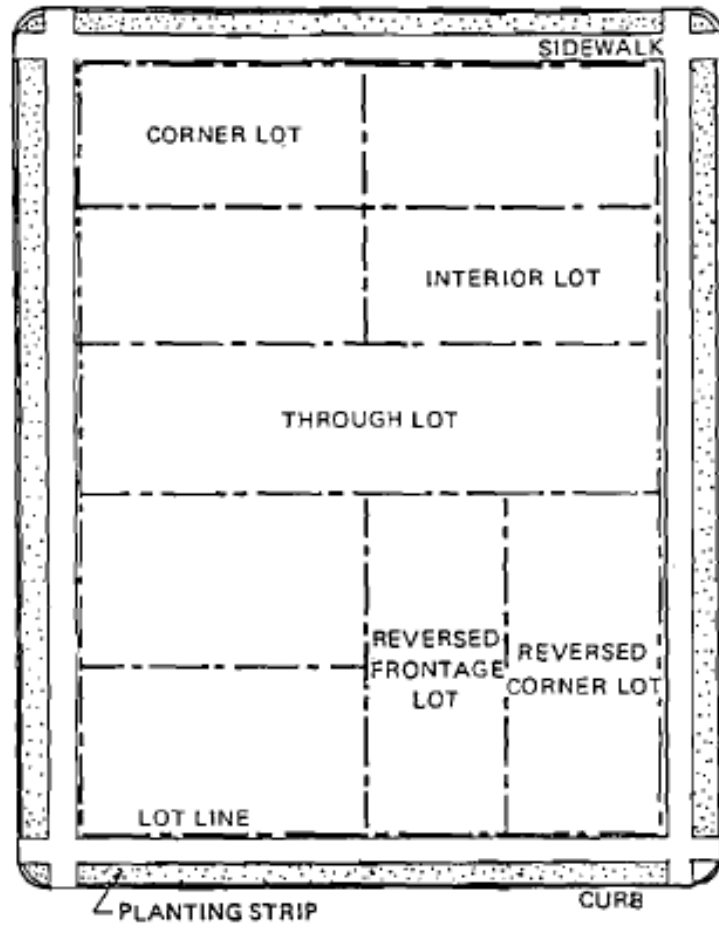

TYPES OF LOTS

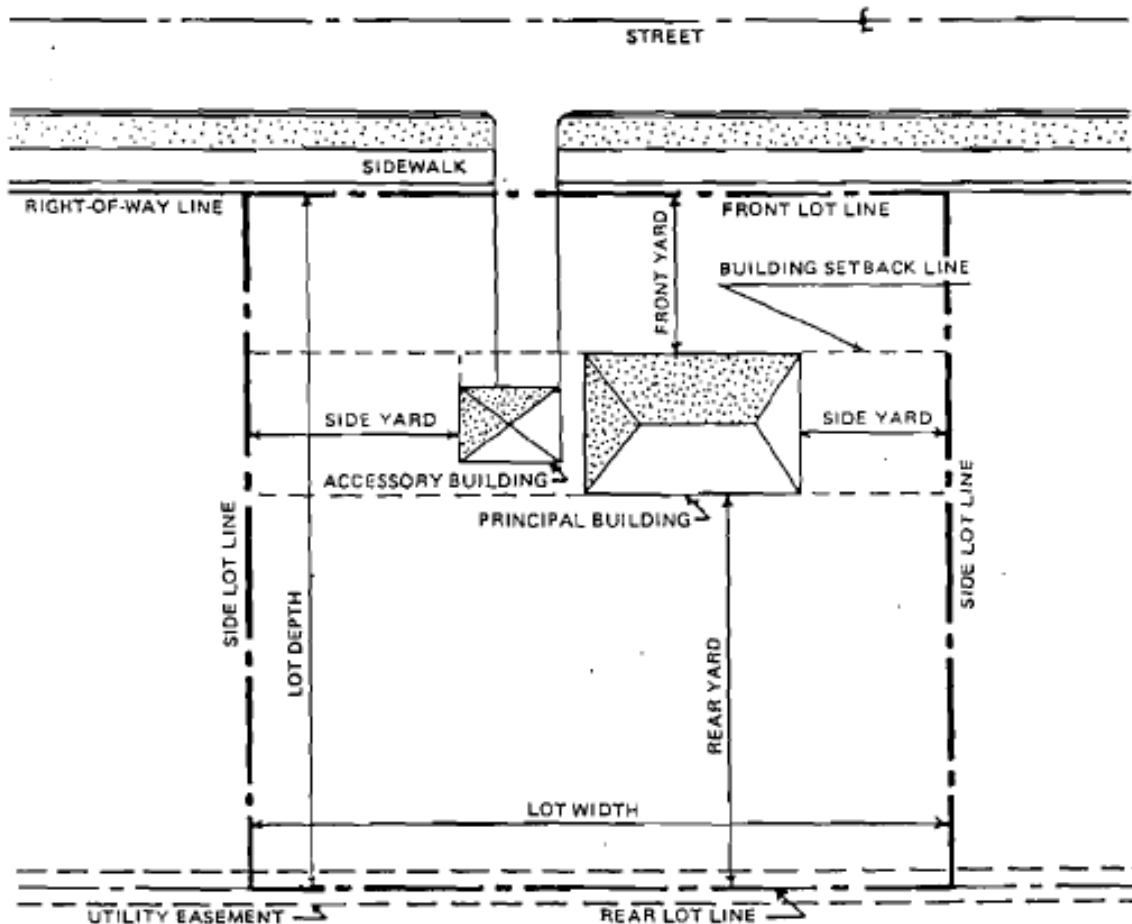

LOT AREA= TOTAL HORIZONTAL AREA

LOT COVERAGE= PER CENT OF LOT OCCUPIED
BY BUILDING

LOT TERMS

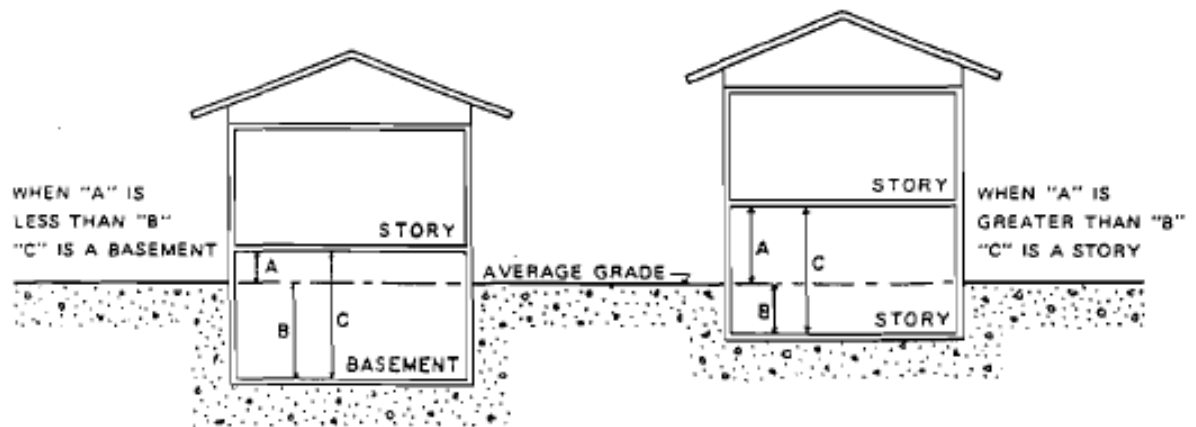

BASEMENT & STORY

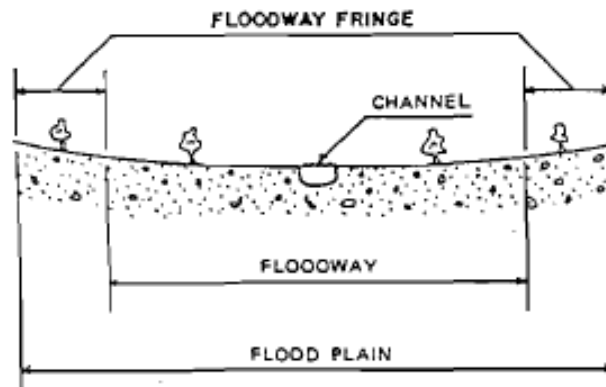

FLOOD PLAIN TERMS

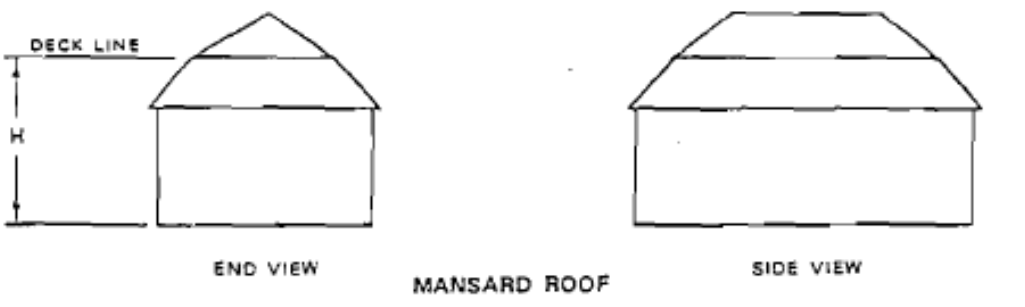
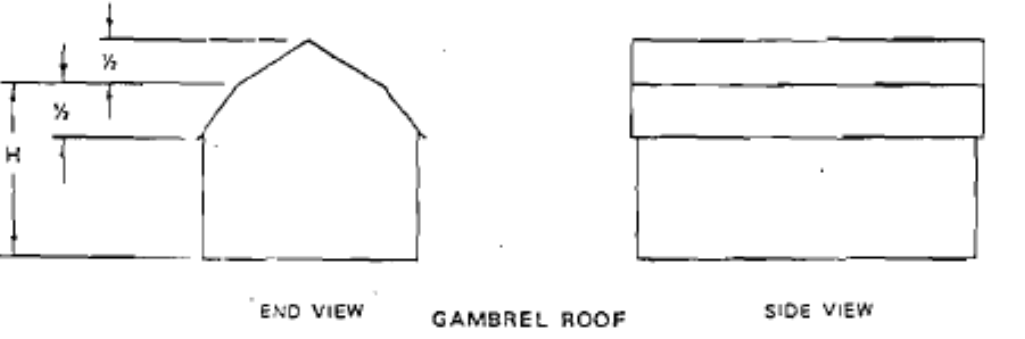
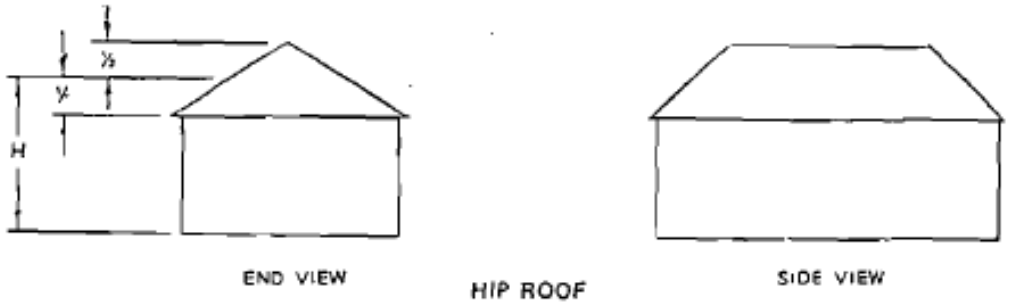
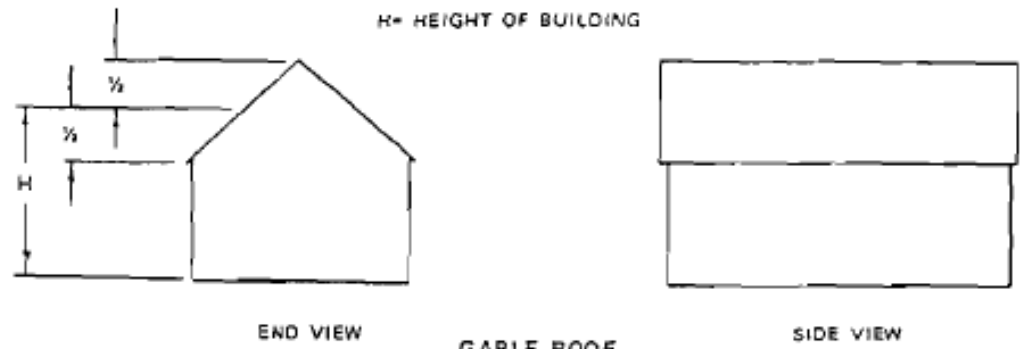

ROOF TYPES AND BUILDING HEIGHT